

HITECH
FASTENERS

Hitech Fasteners, the big source for small fasteners



2017



An Australian Company

CATEGORY 1

METAL THREAD SCREWS

METRIC

PAN PHILLIPS	ZINC	2
PAN PHILLIPS	MECHANICALLY GALVANISED	3
MUSH PHILLIPS HANDLE SCREWS	ZINC	3
PAN PHILLIPS NUMBER PLATE SCREWS	ZINC	3
PAN PHILLIPS	BLACK ZINC	4
PAN POZI	ZINC	4
PAN POZI	BLACK ZINC	5
PAN SLOT	ZINC	5
COUNTERSUNK PHILLIPS	ZINC	6
COUNTERSUNK POZI	ZINC	8
COUNTERSUNK POZI	BLACK ZINC	8
COUNTERSUNK SLOT	ZINC	9
CHEESE COMBINATION	ZINC	11

IMPERIAL

PAN PHILLIPS	ZINC	3
COUNTERSUNK PHILLIPS	ZINC	7
COUNTERSUNK SLOT	ZINC	10
ROUND SLOT	ZINC	10
CHEESE COMBINATION	ZINC	11

CATEGORY 2

UNIFIED & B.A MACHINE SCREWS

UNIFIED

PAN PHILLIPS	ZINC	13
COUNTERSUNK PHILLIPS	ZINC	13

B.A

CHEESE SLOT	ZINC	14
CHEESE SLOT	BRASS	14
COUNTERSUNK SLOT	ZINC	14

CATEGORY 3

BRASS MACHINE SCREWS

METRIC

PAN SLOT	BRASS	16
COUNTERSUNK SLOT	BRASS	17
CHEESE COMBINATION	BRASS	18

IMPERIAL

ROUND SLOT	BRASS	16
COUNTERSUNK SLOT	BRASS	17

CATEGORY 4

MUSH HEAD ROOFING BOLTS

METRIC/IMPERIAL

COMBINATION BOLT ONLY	ZINC	20
COMBINATION BOLT & NUT	ZINC	21
COMBINATION PAINT SCRAPER (MUSH NIB)	ZINC	21

CATEGORY 5

SEMS ASSEMBLY SCREWS

METRIC

PAN 6 - LOBE	ZINC	23
PAN PHILLIPS	ZINC	23

CATEGORY 6

SOLID RIVETS

IMPERIAL

ROUND HEAD	UNPLATED	25
MUSH HEAD	UNPLATED	25

CATEGORY 7

THREAD ROLLING SCREWS

FOR METAL (HI-TITE)

PAN 6 - LOBE	ZINC	27
PAN POZI	ZINC	27
COUNTERSUNK UNDERCUT	ZINC	28
COUNTERSUNK RIBBED	YELLOW ZINC	28
INDENT HEX WASHER HEAD	ZINC	28

FOR PLASTIC (HI-PLAS)

PAN 6 - LOBE	ZINC	29
PAN POZI	ZINC	29

CATEGORY 8

SELF TAPPING SCREWS

PAN PHILLIPS	ZINC	32
PAN PHILLIPS	MECHANICALLY GALVANISED	32
PAN COMBINATION SQUARE/PHILLIPS	ZINC	34
COUNTERSUNK PHILLIPS	ZINC	35
COUNTERSUNK PHILLIPS	MECHANICALLY GALVANISED	35
COUNTERSUNK COMBINATION SQUARE/PHILLIPS	ZINC	35
PAN PHILLIPS	BLACK ZINC	36
COUNTERSUNK PHILLIPS	BLACK ZINC	36
FLANGE PHILLIPS (AUTOMOTIVE)	BLACK ZINC	36

GRAB KIT PAN	ZINC	33
GRAB KIT PAN and CSK	ZINC	35
GRAB KIT FLANGE PHILLIPS	BLACK ZINC	36

CATEGORY 9

NUTS

METRIC

HEXAGON STANDARD COLD FORMED	ZINC	38
HEXAGON STANDARD COLD FORMED	BLACK ZINC	38
HEXAGON STANDARD COLD FORMED	BRASS	39
SQUARE PRESSED	ZINC	40
DOME NUT	CHROME	41
DOME NUT	HOT DIPPED GALVANISED	42
WING NUT	ZINC	42
WING NUT	BRASS	43
WING NUT	MECHANICALLY GALVANISED	43
TEE NUTS	ZINC	43

IMPERIAL

HEXAGON STANDARD COLD FORMED	ZINC	38
------------------------------	------	----

CATEGORY 9 Continued next column

CATEGORY 9 - Continued

IMPERIAL Continued

HEXAGON STANDARD COLD FORMED	BRASS	40
SQUARE PRESSED	ZINC	41
DOME NUT	CHROME	41
WING NUT	ZINC	42
WING NUT	BRASS	43

UNIFIED

HEXAGON STANDARD COLD FORMED	ZINC	39
HEXAGON STANDARD COLD FORMED	BRASS	40

B.A

HEXAGON STANDARD COLD FORMED	ZINC	39
HEXAGON STANDARD COLD FORMED	BRASS	40

CATEGORY 10

THUMB & WING SCREWS

METRIC

THUMB SCREWS	ZINC	45
THUMB SCREWS	STAINLESS STEEL G304	45
WING SCREWS	ZINC	46
WING SCREWS	STAINLESS STEEL G304	46

IMPERIAL

THUMB SCREWS	ZINC	45
THUMB SCREWS	STAINLESS STEEL G304	45

CATEGORY 11

PINS & CLIPS

SPLIT PIN (Cotter Pins)	ZINC	48
SPLIT PIN (Cotter Pins)	STAINLESS STEEL G304	49
SPLIT PIN ASSORTMENT KIT	ZINC	50
R-CLIP (Humpback Pin)	ZINC	51
R-CLIP	STAINLESS STEEL G304	51
R-CLIP Hardware/Hanger Packs	ZINC	52
R-CLIP GRAB KIT	ZINC	53
R-CLIP Retail Stand (Complete Kit)	ZINC	52
R-CLIP HANGER PACKS	STAINLESS STEEL G304	53
HI-SPRING (Spring Tensioned R-Clip)	ZINC	54
DOUBLE COILED R-CLIP	ZINC	54
HAIR PIN RETAINER CLIP	ZINC	54
HAIR PIN GRAB KIT	ZINC	54
LINCH PIN	ZINC YELLOW	55
LINCH PIN	MECHANICALLY GALVANISED	54
LINCH PIN	STAINLESS STEEL MARINE G316	55
LINCH PIN HARDWARE/HANGER PACKS	ZINC YELLOW	55
LINCH PIN GRAB KIT	ZINC YELLOW	55
LINCH PIN HANGER PACKS	STAINLESS STEEL MARINE G316	56
SHAFT LOCKING PIN (PTO CLIP)	ZINC YELLOW	56
	STAINLESS STEEL G304	56

CATEGORY 11 Continued next column

CATEGORY 11 - Continued

PINS & CLIPS - Continued

SHAFT LOCKING PIN SQUARE	YELLOW ZINC	57
SHAFT LOCKING PIN HANGER PACKS	STAINLESS STEEL G304	57
LINCH & SHAFT LOCKING PIN Retail Stand Complete Kit	ZINC YELLOW	58
LINCH,SHAFT LOCKING & R-CLIPS Retail Stand Complete Kit - swivel base	STAINLESS STEEL G304	59
CLEVIS PINS	ZINC	60
CLEVIS PINS GRAB KIT	ZINC	60

CATEGORY 12

BRASS FLAT WASHERS

METRIC/IMPERIAL	BRASS	61
-----------------	-------	----

CATEGORY 13

SECURITY SCREWS

METRIC

PAN HEAD - POST SQUARE /PHILLIPS DRIVE	ZINC ALLOY (SUPER ZINC)	62
COUNTERSUNK HEAD POST - SQUARE /PHILLIPS DRIVE	ZINC ALLOY (SUPER ZINC)	62

CATEGORY 14

U-DRIVE SCREWS

ROUND HEAD	ZINC	63
------------	------	----

CATEGORY 15

DRIVER BITS (1/4 AF)

6-LOBE	64
PHILLIPS	64
COMBINATION/SQUARE PHILLIPS	64
SQUARE	64
SECURITY POST SQUARE/ PHILLIPS	64

CATEGORY 16

WOOD SCREWS

BUGLE BATTEN T17 DECKING SCREW	STAINLESS STEEL G316	66
WOOD SCREW COUNTERSUNK SLOT	SOLID BRASS	66
WOOD SCREW COUNTERSUNK PHILLIPS	STEEL BRASS PLATED	67
WOOD SCREW ROUND COMBINATION PHILLIPS/SLOT	STEEL BRASS PLATED	67

CATEGORY 17

HEXAGON MILD STEEL BOLTS & SET SCREWS

METRIC

BOLTS & NUTS	ZINC	69
SET SCREWS	ZINC	71

IMPERIAL

BOLTS & NUTS	ZINC	70
SET SCREWS	ZINC	71

Category No. and Page Nos. are interactive. Just click on your selected category or page number and PDF will go to selected page. To return to Index click on Index at base of every page.

We offer solutions to fastener problems and the main solution we provide - without fail - is service. Get what you ordered when you need it, we follow your order every step of the way. To order either email info@hitechfasteners.com.au or use our never busy free fax 1800 688 475.

Our aim is to grow our business by expanding yours. Phone us on 02 9602 6200, email or use our free fax number and experience real service.

To us, solutions are more important than sales. We look forward to doing business with you.

A full copy of this catalogue is available on our website in pdf format.

Our service never stops.

www.hitechfasteners.com.au



Fastener products for all fastener needs

METAL THREAD SCREWS

Metric & Imperial

UNIFIED & B.A MACHINE SCREWS

BRASS MACHINE SCREWS

Metric & Imperial

MUSH HEAD ROOFING BOLTS

Metric & Imperial

SEMS ASSEMBLY SCREWS

Metric

SOLID RIVETS

Imperial

THREAD ROLLING SCREWS FOR METAL (HI-TITE) FOR PLASTIC (HI-PLAS)

SELF TAPPING SCREWS

NUTS

Metric & Imperial Unified & B.A

PINS & CLIPS

Steel Zinc Plated & Stainless Steel

THUMB & WING SCREWS

Metric & Imperial

BRASS FLAT WASHERS

Metric & Imperial

SECURITY SCREWS

Metric

U DRIVE SCREWS

DRIVER BITS (1/4 AF)

SCREWS FOR TIMBER

HEXAGON MILD STEEL BOLTS & SET SCREWS

Metric & Imperial



Australia's leading small fastener supplier

HTF121 MIX

STEEL MACHINE SCREWS

Metric & Imperial

Category I

Pan Phillips

Mush Phillips (Handle Screws)

Pan Head Phillips Number Plate Screws

Pan Pozi

Pan Slot

Countersunk Phillips

Countersunk Pozi

Countersunk Slot

Round Slot

Cheese Combination Phillips/Slot



Plating / Material:

- Zinc Clear
- Black Zinc
- Mechanically Galvanised

Specifications:

Pan Metric:	<= M2	DIN 7985
Csk Metric:	M2	DIN 965
Csk Metric:	M12 & M16	JISB1179
Metric:	>=M2.5-M10	AS 1427
Imperial:	1/8"- 3/8"	AS B50
Imperial:	1/2BSW	JIS B1179

INDEX

STEEL MACHINE SCREWS - Category 1

**Pan Head
PHILLIPS
STEEL - METRIC
ZINC PLATED**



M 1.6		Qty
MSPPZP164	1.6 x 4	200
MSPPZP166	1.6 x 6	200
MSPPZP168	1.6 x 8	200
MSPPZP1610	1.6 x 10	200

M 2		Qty
MSPPZP24	2 x 4	200
MSPPZP25	2 x 5	200
MSPPZP26	2 x 6	200
MSPPZP28	2 x 8	200
MSPPZP210	2 x 10	200
MSPPZP212	2 x 12	200
MSPPZP216	2 x 16	200
MSPPZP220	2 x 20	200

M 2.5		Qty
MSPPZP255	2.5 x 5	200
MSPPZP256	2.5 x 6	200
MSPPZP258	2.5 x 8	200
MSPPZP2510	2.5 x 10	200
MSPPZP2512	2.5 x 12	200
MSPPZP2516	2.5 x 16	200
MSPPZP2520	2.5 x 20	200
MSPPZP2525	2.5 x 25	200

M 3		Qty
MSPPZP35	3 x 5	200
MSPPZP36	3 x 6	200
MSPPZP38	3 x 8	200
MSPPZP310	3 x 10	200
MSPPZP312	3 x 12	200
MSPPZP316	3 x 16	200
MSPPZP320	3 x 20	200
MSPPZP325	3 x 25	200
MSPPZP330	3 x 30	200
MSPPZP335	3 x 35	200
MSPPZP340	3 x 40	200
MSPPZP350	3 x 50	200

M 4		Qty
MSPPZP45	4 x 5	200
MSPPZP46	4 x 6	200
MSPPZP48	4 x 8	200
MSPPZP410	4 x 10	200
MSPPZP412	4 x 12	200
MSPPZP416	4 x 16	200
MSPPZP420	4 x 20	200
MSPPZP425	4 x 25	200
MSPPZP430	4 x 30	200
MSPPZP435	4 x 35	200
MSPPZP440	4 x 40	200
MSPPZP445	4 x 45	200
MSPPZP450	4 x 50	200
MSPPZP460	4 x 60	200
MSPPZP465	4 x 65	200
MSPPZP470	4 x 70	200
MSPPZP475	4 x 75	200
MSPPZP4100	4 x 100	200

**Pan Head
PHILLIPS
STEEL - METRIC
MECHANICALLY
GALVANISED**



M 6		Qty
MSPPHP610	6 x 10	200
MSPPHP612	6 x 12	200
MSPPHP616	6 x 16	200
MSPPHP620	6 x 20	200

M 5		Qty
MSPPZP56	5 x 6	200
MSPPZP58	5 x 8	200
MSPPZP510	5 x 10	200
MSPPZP512	5 x 12	200
MSPPZP516	5 x 16	200
MSPPZP520	5 x 20	200
MSPPZP525	5 x 25	200
MSPPZP530	5 x 30	200
MSPPZP535	5 x 35	200
MSPPZP540	5 x 40	200
MSPPZP545	5 x 45	200
MSPPZP550	5 x 50	200
MSPPZP565	5 x 65	200
MSPPZP575	5 x 75	200
MSPPZP5100	5 x 100	200

M 6		Qty
MSPPZP68	6 x 8	200
MSPPZP610	6 x 10	200
MSPPZP612	6 x 12	200
MSPPZP616	6 x 16	200
MSPPZP620	6 x 20	200
MSPPZP625	6 x 25	200
MSPPZP630	6 x 30	200
MSPPZP635	6 x 35	200
MSPPZP640	6 x 40	200
MSPPZP645	6 x 45	200
MSPPZP650	6 x 50	200
MSPPZP665	6 x 65	100
MSPPZP675	6 x 75	100
MSPPZP6100	6 x 100	100

M 6 Continued		Qty
MSPPHP625	6 x 25	200
MSPPHP630	6 x 30	200
MSPPHP640	6 x 40	200

STEEL MACHINE SCREWS - Category 1

**Pan Head
PHILLIPS
STEEL - IMPERIAL
ZINC PLATED**



1/8		Qty
MSPPZP1814	1/8 x 1/4	200
MSPPZP1838	1/8 x 3/8	200
MSPPZP1812	1/8 x 1/2	200
MSPPZP1858	1/8 x 5/8	200
MSPPZP1834	1/8 x 3/4	200
MSPPZP181	1/8 x 1	200
MSPPZP18112	1/8 x 1 1/2	200
MSPPZP182	1/8 x 2	200
MSPPZP183	1/8 x 3	200

5/32		Qty
MSPPZP53214	5/32 x 1/4	200
MSPPZP53238	5/32 x 3/8	200
MSPPZP53212	5/32 x 1/2	200
MSPPZP53258	5/32 x 5/8	200
MSPPZP53234	5/32 x 3/4	200
MSPPZP5321	5/32 x 1	200
MSPPZP532114	5/32 x 1 1/4	200
MSPPZP532112	5/32 x 1 1/2	200
MSPPZP5322	5/32 x 2	200
MSPPZP532214	5/32 x 2 1/4	200
MSPPZP532212	5/32 x 2 1/2	200
MSPPZP5323	5/32 x 3	200

3/16		Qty
MSPPZP31614	3/16 x 1/4	200
MSPPZP31638	3/16 x 3/8	200
MSPPZP31612	3/16 x 1/2	200
MSPPZP31658	3/16 x 5/8	200
MSPPZP31634	3/16 x 3/4	200
MSPPZP3161	3/16 x 1	200
MSPPZP316114	3/16 x 1 1/4	200
MSPPZP316112	3/16 x 1 1/2	200
MSPPZP316134	3/16 x 1 3/4	200
MSPPZP3162	3/16 x 2	200
MSPPZP316214	3/16 x 2 1/4	200
MSPPZP316212	3/16 x 2 1/2	200
MSPPZP3163	3/16 x 3	200
MSPPZP316312	3/16 x 3 1/2	200
MSPPZP3164	3/16 x 4	200

1/4		Qty
MSPPZP1438	1/4 x 3/8	200
MSPPZP1412	1/4 x 1/2	200
MSPPZP1458	1/4 x 5/8	200
MSPPZP1434	1/4 x 3/4	200
MSPPZP141	1/4 x 1	200
MSPPZP14114	1/4 x 1 1/4	200

1/4 Continued		Qty
MSPPZP14112	1/4 x 1 1/2	200
MSPPZP14134	1/4 x 1 3/4	200
MSPPZP142	1/4 x 2	200
MSPPZP14212	1/4 x 2 1/2	100
MSPPZP143	1/4 x 3	100

5/16		Qty
MSPPZP51612	5/16 x 1/2	200
MSPPZP51634	5/16 x 3/4	200
MSPPZP5161	5/16 x 1	200
MSPPZP516114	5/16 x 1 1/4	200
MSPPZP516112	5/16 x 1 1/2	200
MSPPZP5162	5/16 x 2	100
MSPPZP516212	5/16 x 2 1/2	100
MSPPZP5163	5/16 x 3	100

3/8		Qty
MSPPZP3834	3/8 x 3/4	200
MSPPZP381	3/8 x 1	200
MSPPZP38112	3/8 x 1 1/2	200
MSPPZP382	3/8 x 2	100
MSPPZP38212	3/8 x 2 1/2	100
MSPPZP383	3/8 x 3	100

**Mush Head
PHILLIPS
(Handle Screws)
STEEL - METRIC
ZINC PLATED**



M 4		Qty
MSMPZP416	M4 x 16	200
MSMPZP420	M4 x 20	200
MSMPZP422	M4 x 22	200
MSMPZP428	M4 x 28	200

M 4 Continued		Qty
MSMPZP430	M4 x 30	200
MSMPZP432	M4 x 32	200
MSMPZP435	M4 x 35	200
MSMPZP440	M4 x 40	200

**Pan Head
PHILLIPS STEEL
NUMBER PLATE
SCREW Small Head
(10mm Dia.) -
METRIC**



M 6		Qty
MSNPSZP620	6 x 20	200

STEEL MACHINE SCREWS - Category I

**Pan Head
PHILLIPS
STEEL - METRIC
BLACK ZINC PLATED**



M 3		Qty
MSPPBZP36	3 x 6	200
MSPPBZP38	3 x 8	200
MSPPBZP310	3 x 10	200
MSPPBZP312	3 x 12	200

M 4		Qty
MSPPBZP46	4 x 6	200
MSPPBZP48	4 x 8	200
MSPPBZP410	4 x 10	200

M 4 Continued		Qty
MSPPBZP412	4 x 12	200
MSPPBZP416	4 x 16	200
MSPPBZP420	4 x 20	200
MSPPBZP425	4 x 25	200

M 5		Qty
MSPPBZP512	5 x 12	200
MSPPBZP516	5 x 16	200
MSPPBZP520	5 x 20	200
MSPPBZP525	5 x 25	200

M 6		Qty
MSPPBZP612	6 x 12	200
MSPPBZP616	6 x 16	200
MSPPBZP620	6 x 20	200
MSPPBZP625	6 x 25	200
MSPPBZP630	6 x 30	200

**Pan Head
POZI
STEEL - METRIC
ZINC PLATED**



M 2.5		Qty
MSPZZP254	2.5 x 4	200
MSPZZP255	2.5 x 5	200
MSPZZP256	2.5 x 6	200
MSPZZP258	2.5 x 8	200
MSPZZP2510	2.5 x 10	200
MSPZZP2512	2.5 x 12	200
MSPZZP2516	2.5 x 16	200
MSPZZP2520	2.5 x 20	200
MSPZZP2525	2.5 x 25	200

M 3		Qty
MSPZZP35	3 x 5	200
MSPZZP36	3 x 6	200
MSPZZP38	3 x 8	200
MSPZZP310	3 x 10	200
MSPZZP312	3 x 12	200
MSPZZP316	3 x 16	200
MSPZZP320	3 x 20	200
MSPZZP325	3 x 25	200
MSPZZP330	3 x 30	200
MSPZZP335	3 x 35	200

M 4		Qty
MSPZZP46	4 x 6	200
MSPZZP48	4 x 8	200
MSPZZP410	4 x 10	200
MSPZZP412	4 x 12	200

M 4 Continued		Qty
MSPZZP416	4 x 16	200
MSPZZP420	4 x 20	200
MSPZZP425	4 x 25	200
MSPZZP430	4 x 30	200
MSPZZP435	4 x 35	200
MSPZZP440	4 x 40	200
MSPZZP450	4 x 50	200

M 5		Qty
MSPZZP58	5 x 8	200
MSPZZP510	5 x 10	200
MSPZZP512	5 x 12	200
MSPZZP516	5 x 16	200
MSPZZP520	5 x 20	200
MSPZZP525	5 x 25	200
MSPZZP530	5 x 30	200
MSPZZP535	5 x 35	200
MSPZZP540	5 x 40	200
MSPZZP550	5 x 50	200

M 6		Qty
MSPZZP610	6 x 10	200
MSPZZP612	6 x 12	200
MSPZZP616	6 x 16	200
MSPZZP620	6 x 20	200
MSPZZP625	6 x 25	200
MSPZZP630	6 x 30	200

M 6 Continued		Qty
MSPZZP635	6 x 35	200
MSPZZP640	6 x 40	200
MSPZZP650	6 x 50	200
MSPZZP665	6 x 65	100
MSPZZP675	6 x 75	100

M 8		Qty
MSPZZP812	8 x 12	200
MSPZZP816	8 x 16	200
MSPZZP820	8 x 20	200
MSPZZP825	8 x 25	200
MSPZZP830	8 x 30	200
MSPZZP835	8 x 35	200
MSPZZP840	8 x 40	200
MSPZZP850	8 x 50	200
MSPZZP865	8 x 65	100
MSPZZP875	8 x 75	100

M 10		Qty
MSPZZP1020	10 x 20	200
MSPZZP1025	10 x 25	200
MSPZZP1030	10 x 30	100
MSPZZP1040	10 x 40	100
MSPZZP1050	10 x 50	100
MSPZZP1065	10 x 65	100
MSPZZP1075	10 x 75	100

STEEL MACHINE SCREWS - Category I

**Pan Head
POZI
STEEL - METRIC
BLACK ZINC PLATED**



M 3		Qty
MSPZBP36	3 x 6	200
MSPZBP316	3 x 16	200

M 4		Qty
MSPZBP420	4 x 20	200
MSPZBP430	4 x 30	200

M 5		Qty
MSPZBP512	5 x 12	200
MSPZBP516	5 x 16	200
MSPZBP520	5 x 20	200
MSPZBP525	5 x 25	200
MSPZBP530	5 x 30	200

M 6		Qty
MSPZBP620	6 x 20	200
MSPZBP625	6 x 25	200
MSPZBP630	6 x 30	200
MSPZBP640	6 x 40	200
MSPZBP650	6 x 50	200

**Pan Head
SLOT
STEEL - METRIC
ZINC PLATED**



M 2.5		Qty
MSPSZP254	2.5 x 4	200
MSPSZP255	2.5 x 5	200
MSPSZP256	2.5 x 6	200
MSPSZP258	2.5 x 8	200
MSPSZP2510	2.5 x 10	200
MSPSZP2512	2.5 x 12	200
MSPSZP2516	2.5 x 16	200
MSPSZP2520	2.5 x 20	200
MSPSZP2525	2.5 x 25	200

M 3		Qty
MSPSZP35	3 x 5	200
MSPSZP36	3 x 6	200
MSPSZP38	3 x 8	200
MSPSZP310	3 x 10	200
MSPSZP312	3 x 12	200
MSPSZP316	3 x 16	200
MSPSZP320	3 x 20	200
MSPSZP325	3 x 25	200
MSPSZP330	3 x 30	200
MSPSZP335	3 x 35	200

M 3.5		Qty
MSPSZP356	3.5 x 6	200
MSPSZP358	3.5 x 8	200
MSPSZP3510	3.5 x 10	200
MSPSZP3512	3.5 x 12	200

M 3.5 Continued		Qty
MSPSZP3516	3.5 x 16	200
MSPSZP3520	3.5 x 20	200
MSPSZP3525	3.5 x 25	200

M 4		Qty
MSPSZP45	4 x 5	200
MSPSZP46	4 x 6	200
MSPSZP48	4 x 8	200
MSPSZP410	4 x 10	200
MSPSZP412	4 x 12	200
MSPSZP416	4 x 16	200
MSPSZP420	4 x 20	200
MSPSZP425	4 x 25	200
MSPSZP430	4 x 30	200
MSPSZP435	4 x 35	200
MSPSZP440	4 x 40	200
MSPSZP450	4 x 50	200

M 5		Qty
MSPSZP56	5 x 6	200
MSPSZP58	5 x 8	200
MSPSZP510	5 x 10	200
MSPSZP512	5 x 12	200
MSPSZP516	5 x 16	200
MSPSZP520	5 x 20	200
MSPSZP525	5 x 25	200
MSPSZP530	5 x 30	200

M 5 Continued		Qty
MSPSZP540	5 x 40	200
MSPSZP550	5 x 50	200
MSPSZP565	5 x 65	200
MSPSZP575	5 x 75	200

M 6		Qty
MSPSZP610	6 x 10	200
MSPSZP612	6 x 12	200
MSPSZP616	6 x 16	200
MSPSZP620	6 x 20	200
MSPSZP625	6 x 25	200
MSPSZP630	6 x 30	200
MSPSZP635	6 x 35	200
MSPSZP640	6 x 40	200
MSPSZP650	6 x 50	200
MSPSZP665	6 x 65	100
MSPSZP675	6 x 75	100

M 8		Qty
MSPSZP820	8 x 20	100
MSPSZP825	8 x 25	100
MSPSZP830	8 x 30	100
MSPSZP840	8 x 40	100
MSPSZP850	8 x 50	100

M 10		Qty
MSPSZP1050	10 x 50	100

STEEL MACHINE SCREWS - Category I

Countersunk Head
PHILLIPS
STEEL - METRIC
ZINC PLATED



M 2		Qty
MSCPZP25	2 x 5	200
MSCPZP26	2 x 6	200
MSCPZP28	2 x 8	200
MSCPZP210	2 x 10	200
MSCPZP212	2 x 12	200

M 2.5		Qty
MSCPZP255	2.5 x 5	200
MSCPZP256	2.5 x 6	200
MSCPZP258	2.5 x 8	200
MSCPZP2510	2.5 x 10	200
MSCPZP2512	2.5 x 12	200
MSCPZP2516	2.5 x 16	200
MSCPZP2520	2.5 x 20	200
MSCPZP2525	2.5 x 25	200

M 3		Qty
MSCPZP35	3 x 5	200
MSCPZP36	3 x 6	200
MSCPZP38	3 x 8	200
MSCPZP310	3 x 10	200
MSCPZP312	3 x 12	200
MSCPZP316	3 x 16	200

MSCPZP320	3 x 20	200
MSCPZP325	3 x 25	200
MSCPZP330	3 x 30	200
MSCPZP335	3 x 35	200
MSCPZP340	3 x 40	200
MSCPZP345	3 x 45	200
MSCPZP350	3 x 50	200

M 4		Qty
MSCPZP46	4 x 6	200
MSCPZP48	4 x 8	200
MSCPZP410	4 x 10	200
MSCPZP412	4 x 12	200
MSCPZP416	4 x 16	200
MSCPZP420	4 x 20	200
MSCPZP425	4 x 25	200
MSCPZP430	4 x 30	200
MSCPZP435	4 x 35	200
MSCPZP440	4 x 40	200
MSCPZP445	4 x 45	200
MSCPZP450	4 x 50	200
MSCPZP465	4 x 65	200
MSCPZP475	4 x 75	200

M 5		Qty
MSCPZP58	5 x 8	200
MSCPZP510	5 x 10	200
MSCPZP512	5 x 12	200
MSCPZP516	5 x 16	200
MSCPZP520	5 x 20	200
MSCPZP525	5 x 25	200

MSCPZP530	5 x 30	200
MSCPZP535	5 x 35	200
MSCPZP540	5 x 40	200
MSCPZP545	5 x 45	200
MSCPZP550	5 x 50	200
MSCPZP565	5 x 65	200
MSCPZP575	5 x 75	200

M 6		Qty
MSCPZP610	6 x 10	200
MSCPZP612	6 x 12	200
MSCPZP616	6 x 16	200
MSCPZP620	6 x 20	200
MSCPZP625	6 x 25	200
MSCPZP630	6 x 30	200
MSCPZP635	6 x 35	200
MSCPZP640	6 x 40	200
MSCPZP645	6 x 45	200
MSCPZP650	6 x 50	200
MSCPZP665	6 x 65	100
MSCPZP675	6 x 75	100

STEEL MACHINE SCREWS - Category I

Countersunk Head
PHILLIPS
STEEL - IMPERIAL
ZINC PLATED



1/8		Qty
MSCPZP1814	1/8 x 1/4	200
MSCPZP1838	1/8 x 3/8	200
MSCPZP1812	1/8 x 1/2	200
MSCPZP1834	1/8 x 3/4	200
MSCPZP181	1/8 x 1	200

5/32		Qty
MSCPZP53214	5/32 x 1/4	200
MSCPZP53238	5/32 x 3/8	200
MSCPZP53212	5/32 x 1/2	200
MSCPZP53258	5/32 x 5/8	200
MSCPZP53234	5/32 x 3/4	200
MSCPZP5321	5/32 x 1	200
MSCPZP532114	5/32 x 1 1/4	200
MSCPZP532112	5/32 x 1 1/2	200
MSCPZP532134	5/32 x 1 3/4	200
MSCPZP5322	5/32 x 2	200
MSCPZP532212	5/32 x 2 1/2	200
MSCPZP5323	5/32 x 3	200

3/16		Qty
MSCPZP31614	3/16 x 1/4	200
MSCPZP31638	3/16 x 3/8	200
MSCPZP31612	3/16 x 1/2	200
MSCPZP31658	3/16 x 5/8	200
MSCPZP31634	3/16 x 3/4	200
MSCPZP3161	3/16 x 1	200

MSCPZP316114	3/16 x 1 1/4	200
MSCPZP316112	3/16 x 1 1/2	200
MSCPZP316134	3/16 x 1 3/4	200
MSCPZP3162	3/16 x 2	200
MSCPZP316212	3/16 x 2 1/2	200
MSCPZP3163	3/16 x 3	200

1/4		Qty
MSCPZP1438	1/4 x 3/8	200
MSCPZP1412	1/4 x 1/2	200
MSCPZP1458	1/4 x 5/8	200
MSCPZP1434	1/4 x 3/4	200
MSCPZP141	1/4 x 1	200
MSCPZP14114	1/4 x 1 1/4	200
MSCPZP14112	1/4 x 1 1/2	200
MSCPZP14134	1/4 x 1 3/4	200
MSCPZP142	1/4 x 2	200
MSCPZP14212	1/4 x 2 1/2	100
MSCPZP143	1/4 x 3	100

5/16		Qty
MSCPZP51612	5/16 x 1/2	200
MSCPZP51634	5/16 x 3/4	200
MSCPZP5161	5/16 x 1	200
MSCPZP516114	5/16 x 1 1/4	200
MSCPZP516112	5/16 x 1 1/2	200
MSCPZP5162	5/16 x 2	100
MSCPZP516212	5/16 x 2 1/2	100
MSCPZP5163	5/16 x 3	100

3/8		Qty
MSCPZP3834	3/8 x 3/4	200
MSCPZP381	3/8 x 1	200
MSCPZP38114	3/8 x 1 1/4	200
MSCPZP38112	3/8 x 1 1/2	100
MSCPZP382	3/8 x 2	100
MSCPZP38212	3/8 x 2 1/2	100
MSCPZP383	3/8 x 3	100

STEEL MACHINE SCREWS - Category I

Countersunk Head
POZI
STEEL - METRIC
ZINC PLATED



M 2.5		Qty
MSCZZP255	2.5 x 5	200
MSCZZP256	2.5 x 6	200
MSCZZP258	2.5 x 8	200
MSCZZP2510	2.5 x 10	200
MSCZZP2512	2.5 x 12	200
MSCZZP2516	2.5 x 16	200
MSCZZP2520	2.5 x 20	200
MSCZZP2525	2.5 x 25	200

M 3		Qty
MSCZZP35	3 x 5	200
MSCZZP36	3 x 6	200
MSCZZP38	3 x 8	200
MSCZZP310	3 x 10	200
MSCZZP312	3 x 12	200
MSCZZP316	3 x 16	200
MSCZZP320	3 x 20	200
MSCZZP325	3 x 25	200
MSCZZP330	3 x 30	200

M 4		Qty
MSCZZP46	4 x 6	200
MSCZZP48	4 x 8	200
MSCZZP410	4 x 10	200
MSCZZP412	4 x 12	200
MSCZZP416	4 x 16	200
MSCZZP420	4 x 20	200
MSCZZP425	4 x 25	200

M 4 <small>Continued</small>		Qty
MSCZZP430	4 x 30	200
MSCZZP435	4 x 35	200
MSCZZP440	4 x 40	200
MSCZZP450	4 x 50	200

M5		Qty
MSCZZP58	5 x 8	200
MSCZZP510	5 x 10	200
MSCZZP512	5 x 12	200
MSCZZP516	5 x 16	200
MSCZZP520	5 x 20	200
MSCZZP525	5 x 25	200
MSCZZP530	5 x 30	200
MSCZZP540	5 x 40	200
MSCZZP550	5 x 50	200

M 6		Qty
MSCZZP610	6 x 10	200
MSCZZP612	6 x 12	200
MSCZZP616	6 x 16	200
MSCZZP620	6 x 20	200
MSCZZP625	6 x 25	200
MSCZZP630	6 x 30	200
MSCZZP635	6 x 35	200
MSCZZP640	6 x 40	200
MSCZZP645	6 x 45	200
MSCZZP650	6 x 50	200
MSCZZP665	6 x 65	100
MSCZZP675	6 x 75	100

Countersunk Head
POZI
STEEL- METRIC
BLACK ZINC PLATED



M 3		Qty
MSCZBP36	3 x 6	200

M 5		Qty
MSCZBP516	5 x 16	200

STEEL MACHINE SCREWS - Category I

Countersunk Head
SLOT
STEEL- METRIC
ZINC PLATED



M 2.5		Qty
MSCSZP255	2.5 x 5	200
MSCSZP256	2.5 x 6	200
MSCSZP258	2.5 x 8	200
MSCSZP2510	2.5 x 10	200
MSCSZP2512	2.5 x 12	200
MSCSZP2516	2.5 x 16	200
MSCSZP2520	2.5 x 20	200
MSCSZP2525	2.5 x 25	200

M 3		Qty
MSCSZP35	3 x 5	200
MSCSZP36	3 x 6	200
MSCSZP38	3 x 8	200
MSCSZP310	3 x 10	200
MSCSZP312	3 x 12	200
MSCSZP316	3 x 16	200
MSCSZP320	3 x 20	200
MSCSZP325	3 x 25	200
MSCSZP330	3 x 30	200
MSCSZP335	3 x 35	200

M 3.5		Qty
MSCSZP356	3.5 x 6	200
MSCSZP3510	3.5 x 10	200
MSCSZP3512	3.5 x 12	200
MSCSZP3516	3.5 x 16	200
MSCSZP3520	3.5 x 20	200
MSCSZP3525	3.5 x 25	200

M 4		Qty
MSCSZP46	4 x 6	200
MSCSZP48	4 x 8	200
MSCSZP410	4 x 10	200
MSCSZP412	4 x 12	200
MSCSZP416	4 x 16	200
MSCSZP420	4 x 20	200
MSCSZP425	4 x 25	200
MSCSZP430	4 x 30	200
MSCSZP435	4 x 35	200
MSCSZP440	4 x 40	200
MSCSZP450	4 x 50	200

M5		Qty
MSCSZP58	5 x 8	200
MSCSZP510	5 x 10	200
MSCSZP512	5 x 12	200
MSCSZP516	5 x 16	200
MSCSZP520	5 x 20	200
MSCSZP525	5 x 25	200
MSCSZP530	5 x 30	200
MSCSZP540	5 x 40	200
MSCSZP550	5 x 50	200
MSCSZP565	5 x 65	200
MSCSZP575	5 x 75	200

M 6		Qty
MSCSZP610	6 x 10	200
MSCSZP612	6 x 12	200
MSCSZP616	6 x 16	200
MSCSZP620	6 x 20	200
MSCSZP625	6 x 25	200
MSCSZP630	6 x 30	200
MSCSZP635	6 x 35	200
MSCSZP640	6 x 40	200
MSCSZP650	6 x 50	200
MSCSZP665	6 x 65	100
MSCSZP675	6 x 75	100

M 8		Qty
MSCSZP812	8 x 12	200
MSCSZP816	8 x 16	200
MSCSZP820	8 x 20	200
MSCSZP825	8 x 25	200
MSCSZP830	8 x 30	200
MSCSZP835	8 x 35	200
MSCSZP840	8 x 40	200
MSCSZP850	8 x 50	200
MSCSZP865	8 x 65	100
MSCSZP875	8 x 75	100

M 10		Qty
MSCSZP1020	10 x 20	100
MSCSZP1025	10 x 25	100
MSCSZP1030	10 x 30	100
MSCSZP1035	10 x 35	100
MSCSZP1040	10 x 40	100
MSCSZP1050	10 x 50	100
MSCSZP1065	10 x 65	50
MSCSZP1075	10 x 75	50

M 12		Qty
MSCSZP1225	12 x 25	100
MSCSZP1230	12 x 30	100
MSCSZP1240	12 x 40	100
MSCSZP1250	12 x 50	100
MSCSZP1265	12 x 65	50

M 16		Qty
MSCSZP1640	16 x 40	50
MSCSZP1650	16 x 50	25
MSCSZP1665	16 x 65	25

STEEL MACHINE SCREWS - Category I

**Countersunk Head
SLOT**
STEEL - IMPERIAL
ZINC PLATED



1/8		Qty
MSCSZP1814	1/8 x 1/4	200
MSCSZP1838	1/8 x 3/8	200
MSCSZP1812	1/8 x 1/2	200
MSCSZP1858	1/8 x 5/8	200
MSCSZP1834	1/8 x 3/4	200
MSCSZP181	1/8 x 1	200
MSCSZP18114	1/8 x 1 1/4	200
MSCSZP18112	1/8 x 1 1/2	200

5/32		Qty
MSCSZP53214	5/32 x 1/4	200
MSCSZP53238	5/32 x 3/8	200
MSCSZP53212	5/32 x 1/2	200
MSCSZP53258	5/32 x 5/8	200
MSCSZP53234	5/32 x 3/4	200
MSCSZP5321	5/32 x 1	200
MSCSZP532114	5/32 x 1 1/4	200
MSCSZP532112	5/32 x 1 1/2	200
MSCSZP532134	5/32 x 1 3/4	200
MSCSZP5322	5/32 x 2	200

3/16		Qty
MSCSZP31614	3/16 x 1/4	200
MSCSZP31638	3/16 x 3/8	200
MSCSZP31612	3/16 x 1/2	200
MSCSZP31658	3/16 x 5/8	200
MSCSZP31634	3/16 x 3/4	200
MSCSZP3161	3/16 x 1	200
MSCSZP316114	3/16 x 1 1/4	200
MSCSZP316112	3/16 x 1 1/2	200
MSCSZP316134	3/16 x 1 3/4	200
MSCSZP3162	3/16 x 2	200
MSCSZP316212	3/16 x 2 1/2	200
MSCSZP3163	3/16 x 3	200

1/4		Qty
MSCSZP1438	1/4 x 3/8	200
MSCSZP1412	1/4 x 1/2	200
MSCSZP1458	1/4 x 5/8	200
MSCSZP1434	1/4 x 3/4	200
MSCSZP141	1/4 x 1	200
MSCSZP14114	1/4 x 1 1/4	200

1/4 Continued		Qty
MSCSZP14112	1/4 x 1 1/2	200
MSCSZP14134	1/4 x 1 3/4	200
MSCSZP142	1/4 x 2	200
MSCSZP14212	1/4 x 2 1/2	100
MSCSZP143	1/4 x 3	100

5/16		Qty
MSCSZP51612	5/16 x 1/2	100
MSCSZP51634	5/16 x 3/4	100
MSCSZP5161	5/16 x 1	100
MSCSZP516114	5/16 x 1 1/4	100
MSCSZP516112	5/16 x 1 1/2	100
MSCSZP5162	5/16 x 2	100

1/2		Qty
MSCSZP121	1/2 x 1	100
MSCSZP12114	1/2 x 1 1/4	100
MSCSZP12112	1/2 x 1 1/2	100
MSCSZP122	1/2 x 2	100

**Round Head
SLOT**
STEEL - IMPERIAL
ZINC PLATED



1/8		Qty
MSRSZP18316	1/8 x 3/16	200
MSRSZP1814	1/8 x 1/4	200
MSRSZP1838	1/8 x 3/8	200
MSRSZP1812	1/8 x 1/2	200
MSRSZP1858	1/8 x 5/8	200
MSRSZP1834	1/8 x 3/4	200
MSRSZP181	1/8 x 1	200
MSRSZP18114	1/8 x 1 1/4	200
MSRSZP18112	1/8 x 1 1/2	200
MSRSZP182	1/8 x 2	200

5/32		Qty
MSRSZP53214	5/32 x 1/4	200
MSRSZP53238	5/32 x 3/8	200
MSRSZP53212	5/32 x 1/2	200
MSRSZP53258	5/32 x 5/8	200
MSRSZP53234	5/32 x 3/4	200

5/32 Continued		Qty
MSRSZP5321	5/32 x 1	200
MSRSZP532114	5/32 x 1 1/4	200
MSRSZP532112	5/32 x 1 1/2	200
MSRSZP532134	5/32 x 1 3/4	200
MSRSZP5322	5/32 x 2	200

3/16		Qty
MSRSZP31614	3/16 x 1/4	200
MSRSZP31638	3/16 x 3/8	200
MSRSZP31612	3/16 x 1/2	200
MSRSZP31658	3/16 x 5/8	200
MSRSZP31634	3/16 x 3/4	200
MSRSZP3161	3/16 x 1	200
MSRSZP316114	3/16 x 1 1/4	200
MSRSZP316112	3/16 x 1 1/2	200
MSRSZP316134	3/16 x 1 3/4	200
MSRSZP3162	3/16 x 2	200

3/16 Continued		Qty
MSRSZP316212	3/16 x 2 1/2	200
MSRSZP3163	3/16 x 3	200

1/4		Qty
MSRSZP1438	1/4 x 3/8	200
MSRSZP1412	1/4 x 1/2	200
MSRSZP1458	1/4 x 5/8	200
MSRSZP1434	1/4 x 3/4	200
MSRSZP141	1/4 x 1	200
MSRSZP14114	1/4 x 1 1/4	200
MSRSZP14112	1/4 x 1 1/2	200
MSRSZP14134	1/4 x 1 3/4	200
MSRSZP142	1/4 x 2	200
MSRSZP14212	1/4 x 2 1/2	100
MSRSZP143	1/4 x 3	100

5/16		Qty
MSRSZP5161	5/16 x 1	200

STEEL MACHINE SCREWS - Category I

**Cheese Head
COMBINATION
PHILLIPS/SLOT**
STEEL - METRIC
ZINC PLATED



M 2.5		Qty
MSCCZP255	2.5 x 5	200
MSCCZP256	2.5 x 6	200
MSCCZP258	2.5 x 8	200
MSCCZP2510	2.5 x 10	200
MSCCZP2512	2.5 x 12	200
MSCCZP2516	2.5 x 16	200
MSCCZP2520	2.5 x 20	200

M 3		Qty
MSCCZP36	3 x 6	200
MSCCZP38	3 x 8	200
MSCCZP310	3 x 10	200
MSCCZP312	3 x 12	200
MSCCZP316	3 x 16	200
MSCCZP320	3 x 20	200
MSCCZP325	3 x 25	200
MSCCZP330	3 x 30	200

M 4		Qty
MSCCZP46	4 x 6	200
MSCCZP48	4 x 8	200
MSCCZP410	4 x 10	200
MSCCZP412	4 x 12	200
MSCCZP416	4 x 16	200
MSCCZP420	4 x 20	200
MSCCZP425	4 x 25	200
MSCCZP430	4 x 30	200
MSCCZP440	4 x 40	200
MSCCZP450	4 x 50	200

M 5		Qty
MSCCZP58	5 x 8	200
MSCCZP510	5 x 10	200
MSCCZP512	5 x 12	200
MSCCZP516	5 x 16	200
MSCCZP520	5 x 20	200
MSCCZP525	5 x 25	200
MSCCZP530	5 x 30	200
MSCCZP540	5 x 40	200
MSCCZP550	5 x 50	200

M 6		Qty
MSCCZP610	6 x 10	200
MSCCZP612	6 x 12	200
MSCCZP616	6 x 16	200
MSCCZP620	6 x 20	200
MSCCZP625	6 x 25	200
MSCCZP630	6 x 30	200
MSCCZP640	6 x 40	200
MSCCZP650	6 x 50	200

**Cheese Head
COMBINATION
PHILLIPS/SLOT**
STEEL - IMPERIAL
ZINC PLATED



1/8		Qty
MSCCZP1814	1/8 x 1/4	200
MSCCZP1838	1/8 x 3/8	200
MSCCZP1812	1/8 x 1/2	200
MSCCZP1834	1/8 x 3/4	200
MSCCZP181	1/8 x 1	200

5/32		Qty
MSCCZP53214	5/32 x 1/4	200
MSCCZP53238	5/32 x 3/8	200
MSCCZP53212	5/32 x 1/2	200
MSCCZP53234	5/32 x 3/4	200
MSCCZP5321	5/32 x 1	200

3/16		Qty
MSCCZP31638	3/16 x 3/8	200
MSCCZP31612	3/16 x 1/2	200
MSCCZP31658	3/16 x 5/8	200
MSCCZP31634	3/16 x 3/4	200
MSCCZP3161	3/16 x 1	200
MSCCZP316112	3/16 x 1 1/2	200
MSCCZP3162	3/16 x 2	200

1/4		Qty
MSCCZP1438	1/4 x 3/8	200
MSCCZP1412	1/4 x 1/2	200
MSCCZP1458	1/4 x 5/8	200
MSCCZP1434	1/4 x 3/4	200
MSCCZP141	1/4 x 1	200
MSCCZP14114	1/4 x 1 1/4	200
MSCCZP14112	1/4 x 1 1/2	200
MSCCZP142	1/4 x 2	200

UNIFIED & B.A MACHINE SCREWS

Category 2

Pan Phillips



13

Countersunk Phillips

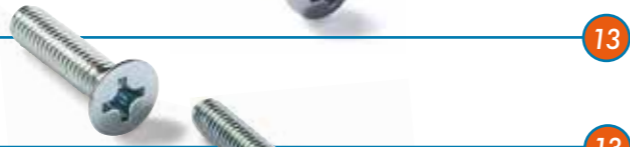

13

Cheese Slot



14

Countersunk Slot



14

Plating / Material:

Zinc Clear

Brass

Specifications:

Unified: ANSI B18.6.3

B.A: AS B85

UNIFIED & B.A MACHINE SCREWS - Category 2

**Pan Head
PHILLIPS
STEEL - UNIFIED
ZINC PLATED**



2-56		Qty
MSPPPZP256316	2-56 x 3/16	200
MSPPPZP25638	2-56 x 3/8	200
MSPPPZP25612	2-56 x 1/2	200

4-40		Qty
MSPPPZP44014	4-40 x 1/4	200
MSPPPZP44038	4-40 x 3/8	200
MSPPPZP44012	4-40 x 1/2	200
MSPPPZP44034	4-40 x 3/4	200
MSPPPZP4401	4-40 x 1	200
MSPPPZP440112	4-40 x 1 1/2	200

6-32		Qty
MSPPPZP63214	6-32 x 1/4	200
MSPPPZP63238	6-32 x 3/8	200
MSPPPZP63212	6-32 x 1/2	200
MSPPPZP63234	6-32 x 3/4	200
MSPPPZP6321	6-32 x 1	200
MSPPPZP632112	6-32 x 1 1/2	200

8-32		Qty
MSPPPZP83214	8-32 x 1/4	200
MSPPPZP83238	8-32 x 3/8	200
MSPPPZP83212	8-32 x 1/2	200
MSPPPZP83234	8-32 x 3/4	200
MSPPPZP8321	8-32 x 1	200
MSPPPZP832112	8-32 x 1 1/2	200

10-32 UNF		Qty
MSPPPZP103238	10-32 x 3/8	200
MSPPPZP103212	10-32 x 1/2	200
MSPPPZP103234	10-32 x 3/4	200
MSPPPZP10321	10-32 x 1	200
MSPPPZP1032112	10-32 x 1 1/2	200

**Countersunk Head
PHILLIPS
STEEL - UNIFIED
ZINC PLATED**



2-56		Qty
MSCPZP256316	2-56 x 3/16	200
MSCPZP25638	2-56 x 3/8	200
MSCPZP25612	2-56 x 1/2	200

4-40		Qty
MSCPZP44014	4-40 x 1/4	200
MSCPZP44012	4-40 x 1/2	200
MSCPZP44034	4-40 x 3/4	200
MSCPZP4401	4-40 x 1	200
MSCPZP440112	4-40 x 1 1/2	200

6-32		Qty
MSCPZP63214	6-32 x 1/4	200
MSCPZP63212	6-32 x 1/2	200
MSCPZP63234	6-32 x 3/4	200
MSCPZP6321	6-32 x 1	200
MSCPZP632112	6-32 x 1 1/2	200

8-32		Qty
MSCPZP83214	8-32 x 1/4	200
MSCPZP83212	8-32 x 1/2	200
MSCPZP83234	8-32 x 3/4	200
MSCPZP8321	8-32 x 1	200
MSCPZP832112	8-32 x 1 1/2	200

10-32 UNF		Qty
MSCPZP103238	10-32 x 3/8	200
MSCPZP103212	10-32 x 1/2	200
MSCPZP103234	10-32 x 3/4	200
MSCPZP10321	10-32 x 1	200
MSCPZP1032112	10-32 x 1 1/2	200

UNIFIED & B.A MACHINE SCREWS - Category 2

**B.A Cheese Head
SLOT
STEEL - B.A
ZINC PLATED**



2BA		Qty
MSCHSZP2BA12	2BA x 1/2	200
MSCHSZP2BA34	2BA x 3/4	200
MSCHSZP2BA1	2BA x 1	200
MSCHSZP2BA112	2BA x 1 1/2	200

4BA		Qty
MSCHSZP4BA12	4BA x 1/2	200
MSCHSZP4BA34	4BA x 3/4	200
MSCHSZP4BA1	4BA x 1	200
MSCHSZP4BA112	4BA x 1 1/2	200

6BA		Qty
MSCHSZP6BA12	6BA x 1/2	200
MSCHSZP6BA34	6BA x 3/4	200
MSCHSZP6BA1	6BA x 1	200
MSCHSZP6BA112	6BA x 1 1/2	200

**B.A Countersunk Head
SLOT
STEEL - B.A
ZINC PLATED**



2BA		Qty
MSCSZP2BA12	2BA x 1/2	200
MSCSZP2BA34	2BA x 3/4	200
MSCSZP2BA1	2BA x 1	200
MSCSZP2BA112	2BA x 1 1/2	200

4BA		Qty
MSCSZP4BA12	4BA x 1/2	200
MSCSZP4BA34	4BA x 3/4	200
MSCSZP4BA1	4BA x 1	200
MSCSZP4BA112	4BA x 1 1/2	200

6BA		Qty
MSCSZP6BA12	6BA x 1/2	200
MSCSZP6BA34	6BA x 3/4	200
MSCSZP6BA1	6BA x 1	200
MSCSZP6BA112	6BA x 1 1/2	200

**B.A Cheese Head
SLOT
BRASS - B.A**



2BA		Qty
BRCHSP2BA12	2BA x 1/2	200
BRCHSP2BA34	2BA x 3/4	200
BRCHSP2BA1	2BA x 1	200
BRCHSP2BA112	2BA x 1 1/2	200

4BA		Qty
BRCHSP4BA12	4BA x 1/2	200
BRCHSP4BA34	4BA x 3/4	200
BRCHSP4BA1	4BA x 1	200
BRCHSP4BA112	4BA x 1 1/2	200

6BA		Qty
BRCHSP6BA12	6BA x 1/2	200
BRCHSP6BA34	6BA x 3/4	200
BRCHSP6BA1	6BA x 1	200
BRCHSP6BA112	6BA x 1 1/2	200

BRASS MACHINE SCREWS

Category 3

Pan Slot



16

Round Slot



16

Countersunk Slot



17

Cheese Combination
Phillips/Slot

18

Plating / Material:

Brass

Specifications:

Metric: AS 1427

Imperial: AS B50

BRASS MACHINE SCREWS - Category 3

Pan Head SLOT BRASS - METRIC



M 2.5		Qty
BRPSP256	2.5 x 6	200
BRPSP258	2.5 x 8	200
BRPSP2510	2.5 x 10	200
BRPSP2512	2.5 x 12	200
BRPSP2516	2.5 x 16	200
BRPSP2520	2.5 x 20	200
BRPSP2525	2.5 x 25	200

M 3		Qty
BRPSP35	3 x 5	200
BRPSP36	3 x 6	200
BRPSP38	3 x 8	200
BRPSP310	3 x 10	200
BRPSP312	3 x 12	200
BRPSP316	3 x 16	200
BRPSP320	3 x 20	200
BRPSP325	3 x 25	200
BRPSP330	3 x 30	200
BRPSP340	3 x 40	200
BRPSP350	3 x 50	200

M 4		Qty
BRPSP46	4 x 6	200
BRPSP48	4 x 8	200
BRPSP410	4 x 10	200
BRPSP412	4 x 12	200
BRPSP416	4 x 16	200
BRPSP420	4 x 20	200
BRPSP425	4 x 25	200
BRPSP430	4 x 30	200
BRPSP440	4 x 40	200
BRPSP450	4 x 50	200
BRPSP465	4 x 65	200

M 5		Qty
BRPSP56	5 x 6	200
BRPSP58	5 x 8	200
BRPSP510	5 x 10	200
BRPSP512	5 x 12	200
BRPSP516	5 x 16	200
BRPSP520	5 x 20	200
BRPSP525	5 x 25	200
BRPSP530	5 x 30	200
BRPSP540	5 x 40	200
BRPSP550	5 x 50	200

M 6		Qty
BRPSP610	6 x 10	200
BRPSP612	6 x 12	200
BRPSP616	6 x 16	200
BRPSP620	6 x 20	200
BRPSP625	6 x 25	200
BRPSP630	6 x 30	200
BRPSP640	6 x 40	200
BRPSP650	6 x 50	200

M 8		Qty
BRPSP820	8 x 20	50
BRPSP825	8 x 25	50
BRPSP830	8 x 30	50
BRPSP840	8 x 40	50
BRPSP850	8 x 50	50

M 10		Qty
BRPSP1020	10 x 20	50
BRPSP1025	10 x 25	50
BRPSP1030	10 x 30	50
BRPSP1040	10 x 40	50
BRPSP1050	10 x 50	50

Round Head SLOT BRASS - IMPERIAL



1/8		Qty
BRRSP1814	1/8 x 1/4	200
BRRSP1838	1/8 x 3/8	200
BRRSP1812	1/8 x 1/2	200
BRRSP1858	1/8 x 5/8	200
BRRSP1834	1/8 x 3/4	200
BRRSP181	1/8 x 1	200
BRRSP18114	1/8 x 1 1/4	200
BRRSP18112	1/8 x 1 1/2	200
BRRSP182	1/8 x 2	200

5/32		Qty
BRRSP53214	5/32 x 1/4	200
BRRSP53238	5/32 x 3/8	200
BRRSP53212	5/32 x 1/2	200
BRRSP53258	5/32 x 5/8	200
BRRSP53234	5/32 x 3/4	200
BRRSP5321	5/32 x 1	200

5/32 Continued		Qty
BRRSP532114	5/32 x 1 1/4	200
BRRSP532112	5/32 x 1 1/2	200
BRRSP5322	5/32 x 2	200

3/16		Qty
BRRSP31614	3/16 x 1/4	200
BRRSP31638	3/16 x 3/8	200
BRRSP31612	3/16 x 1/2	200
BRRSP31658	3/16 x 5/8	200
BRRSP31634	3/16 x 3/4	200
BRRSP3161	3/16 x 1	200
BRRSP316114	3/16 x 1 1/4	200
BRRSP316112	3/16 x 1 1/2	200
BRRSP316134	3/16 x 1 3/4	200
BRRSP3162	3/16 x 2	200
BRRSP316212	3/16 x 2 1/2	200
BRRSP3163	3/16 x 3	200

1/4		Qty
BRRSP1438	1/4 x 3/8	200
BRRSP1412	1/4 x 1/2	200
BRRSP1458	1/4 x 5/8	200
BRRSP1434	1/4 x 3/4	200
BRRSP141	1/4 x 1	200
BRRSP14114	1/4 x 1 1/4	200
BRRSP14112	1/4 x 1 1/2	200
BRRSP142	1/4 x 2	200
BRRSP14212	1/4 x 2 1/2	100
BRRSP143	1/4 x 3	100

5/16		Qty
BRRSP51634	5/16 x 3/4	50
BRRSP5161	5/16 x 1	50
BRRSP516112	5/16 x 1 1/2	50
BRRSP5162	5/16 x 2	50

BRASS MACHINE SCREWS - Category 3

Countersunk Head SLOT BRASS - METRIC



M 2.5		Qty
BRCSP256	2.5 x 6	200
BRCSP258	2.5 x 8	200
BRCSP2510	2.5 x 10	200
BRCSP2512	2.5 x 12	200
BRCSP2516	2.5 x 16	200
BRCSP2520	2.5 x 20	200
BRCSP2525	2.5 x 25	200

M 3		Qty
BRCSP36	3 x 6	200
BRCSP38	3 x 8	200
BRCSP310	3 x 10	200
BRCSP312	3 x 12	200
BRCSP316	3 x 16	200
BRCSP320	3 x 20	200
BRCSP325	3 x 25	200
BRCSP330	3 x 30	200

M 4		Qty
BRCSP46	4 x 6	200
BRCSP48	4 x 8	200
BRCSP410	4 x 10	200
BRCSP412	4 x 12	200
BRCSP416	4 x 16	200
BRCSP420	4 x 20	200
BRCSP425	4 x 25	200
BRCSP430	4 x 30	200
BRCSP440	4 x 40	200
BRCSP450	4 x 50	200

M 5		Qty
BRCSP510	5 x 10	200
BRCSP512	5 x 12	200
BRCSP516	5 x 16	200
BRCSP520	5 x 20	200
BRCSP525	5 x 25	200
BRCSP530	5 x 30	200
BRCSP540	5 x 40	200
BRCSP550	5 x 50	200

M 6		Qty
BRCSP610	6 x 10	200
BRCSP612	6 x 12	200
BRCSP616	6 x 16	200
BRCSP620	6 x 20	200
BRCSP625	6 x 25	200
BRCSP630	6 x 30	200
BRCSP640	6 x 40	200
BRCSP650	6 x 50	200

M 8		Qty
BRCSP820	8 x 20	50
BRCSP825	8 x 25	50
BRCSP830	8 x 30	50
BRCSP840	8 x 40	50
BRCSP850	8 x 50	50

M 10		Qty
BRCSP1020	10 x 20	50
BRCSP1025	10 x 25	50
BRCSP1030	10 x 30	50
BRCSP1040	10 x 40	50
BRCSP1050	10 x 50	50

Countersunk Head SLOT BRASS - IMPERIAL



1/8		Qty
BRCSP1814	1/8 x 1/4	200
BRCSP1838	1/8 x 3/8	200
BRCSP1812	1/8 x 1/2	200
BRCSP1834	1/8 x 3/4	200
BRCSP181	1/8 x 1	200
BRCSP18114	1/8 x 1 1/4	200
BRCSP18112	1/8 x 1 1/2	200
BRCSP182	1/8 x 2	200

5/32		Qty
BRCSP53238	5/32 x 3/8	200
BRCSP53212	5/32 x 1/2	200
BRCSP53234	5/32 x 3/4	200
BRCSP5321	5/32 x 1	200
BRCSP532114	5/32 x 1 1/4	200
BRCSP532112	5/32 x 1 1/2	200
BRCSP5322	5/32 x 2	200

3/16		Qty
BRCSP31614	3/16 x 1/4	200
BRCSP31638	3/16 x 3/8	200
BRCSP31612	3/16 x 1/2	200
BRCSP31658	3/16 x 5/8	200
BRCSP31634	3/16 x 3/4	200
BRCSP3161	3/16 x 1	200
BRCSP316114	3/16 x 1 1/4	200
BRCSP316112	3/16 x 1 1/2	200
BRCSP3162	3/16 x 2	200
BRCSP316212	3/16 x 2 1/2	200
BRCSP3163	3/16 x 3	200

1/4		Qty
BRCSP1412	1/4 x 1/2	200
BRCSP1458	1/4 x 5/8	200
BRCSP1434	1/4 x 3/4	200
BRCSP141	1/4 x 1	200

1/4 Continued		Qty
BRCSP14114	1/4 x 1 1/4	200
BRCSP14112	1/4 x 1 1/2	200
BRCSP142	1/4 x 2	200
BRCSP14212	1/4 x 2 1/2	100
BRCSP143	1/4 x 3	100

5/16		Qty
BRCSP51634	5/16 x 3/4	50
BRCSP5161	5/16 x 1	50
BRCSP516114	5/16 x 1 1/4	50
BRCSP516112	5/16 x 1 1/2	50
BRCSP5162	5/16 x 2	50

3/8		Qty
BRCSP3834	3/8 x 3/4	50
BRCSP381	3/8 x 1	50
BRCSP38112	3/8 x 1 1/2	50
BRCSP382	3/8 x 2	50

BRASS MACHINE SCREWS - Category 3

**Cheese Head
COMBINATION
PHILLIPS/SLOT
BRASS - METRIC**



M 3		Qty
BRCCP36	3 x 6	200
BRCCP38	3 x 8	200
BRCCP310	3 x 10	200
BRCCP312	3 x 12	200

M 4		Qty
BRCCP410	4 x 10	200
BRCCP412	4 x 12	200
BRCCP416	4 x 16	200
BRCCP420	4 x 20	200
BRCCP425	4 x 25	200

M 5		Qty
BRCCP510	5 x 10	200
BRCCP512	5 x 12	200
BRCCP516	5 x 16	200
BRCCP520	5 x 20	200
BRCCP525	5 x 25	200

M 6		Qty
BRCCP612	6 x 12	200
BRCCP616	6 x 16	200
BRCCP620	6 x 20	200
BRCCP625	6 x 25	200

MUSH HEAD ROOFING BOLTS

Category 4

**Mush Head Combination
Phillips/Slot
Roof Bolt Only**



20

**Mush Head Combination
Phillips/Slot
Roof Bolt & Nut**



21

**Mush Nib Combination
Phillips/Slot
(Paint Scraper)**



21

Plating / Material:

Zinc Clear

Specifications:

Roof Bolts: Refer Drawing
 Nuts: 3/16 – ASB50
 Nuts: 1/4 - 5/16 – AS 2451
 Nuts: M5 & M6 – AS 1112
 Mush Nib: Refer Drawing

MUSH HEAD ROOFING BOLTS - Category 4

**Mush Head
Roof Bolt Only
PHILLIPS/SLOT
STEEL - METRIC
ZINC PLATED**



M 5		Qty	M 6		Qty
MSRBZP510	5 x 10	200	MSRBZP610	6 x 10	200
MSRBZP512	5 x 12	200	MSRBZP612	6 x 12	200
MSRBZP516	5 x 16	200	MSRBZP616	6 x 16	200
MSRBZP520	5 x 20	200	MSRBZP620	6 x 20	200
MSRBZP525	5 x 25	200	MSRBZP625	6 x 25	200
			MSRBZP630	6 x 30	200
			MSRBZP640	6 x 40	200
			MSRBZP650	6 x 50	200

**Mush Head
Roof Bolt Only
PHILLIPS/SLOT
STEEL - IMPERIAL**



3/16		Qty	1/4		Qty
MSRBZP31614	3/16 x 1/4	200	MSRBZP1414	1/4 x 1/4	200
MSRBZP31638	3/16 x 3/8	200	MSRBZP1438	1/4 x 3/8	200
MSRBZP31612	3/16 x 1/2	200	MSRBZP1412	1/4 x 1/2	200
MSRBZP31658	3/16 x 5/8	200	MSRBZP1458	1/4 x 5/8	200
MSRBZP31634	3/16 x 3/4	200	MSRBZP1434	1/4 x 3/4	200
MSRBZP3161	3/16 x 1	200	MSRBZP141	1/4 x 1	200
MSRBZP316114	3/16 x 1 1/4	200	MSRBZP14114	1/4 x 1 1/4	200
MSRBZP316112	3/16 x 1 1/2	200	MSRBZP14112	1/4 x 1 1/2	200
MSRBZP316134	3/16 x 1 3/4	200	MSRBZP14134	1/4 x 1 3/4	200
MSRBZP3162	3/16 x 2	200	MSRBZP142	1/4 x 2	200
MSRBZP316212	3/16 x 2 1/2	200	MSRBZP14212	1/4 x 2 1/2	100
MSRBZP3163	3/16 x 3	200	MSRBZP143	1/4 x 3	100

5/16		Qty
MSRBZP51612	5/16 x 1/2	200
MSRBZP51658	5/16 x 5/8	200
MSRBZP51634	5/16 x 3/4	200
MSRBZP5161	5/16 x 1	200
MSRBZP516114	5/16 x 1 1/4	200
MSRBZP516112	5/16 x 1 1/2	200
MSRBZP5162	5/16 x 2	200
MSRBZP516212	5/16 x 2 1/2	100
MSRBZP5163	5/16 x 3	100

MUSH HEAD ROOFING BOLTS - Category 4

**Mush Head
Roof Bolt and Nut
PHILLIPS/SLOT
STEEL - METRIC
ZINC PLATED**



M 5		Qty	M 6		Qty
MSRNZP510	5 x 10	200	MSRNZP610	6 x 10	200
MSRNZP512	5 x 12	200	MSRNZP612	6 x 12	200
MSRNZP516	5 x 16	200	MSRNZP616	6 x 16	200
MSRNZP520	5 x 20	200	MSRNZP620	6 x 20	200
MSRNZP525	5 x 25	200	MSRNZP625	6 x 25	200
			MSRNZP630	6 x 30	200
			MSRNZP640	6 x 40	200
			MSRNZP650	6 x 50	200

**Mush Head
Roof Bolt and Nut
PHILLIPS/SLOT
STEEL - IMPERIAL
ZINC PLATED**



3/16		Qty
MSRNZP31614	3/16 x 1/4	200
MSRNZP31638	3/16 x 3/8	200
MSRNZP31612	3/16 x 1/2	200
MSRNZP31658	3/16 x 5/8	200
MSRNZP31634	3/16 x 3/4	200
MSRNZP3161	3/16 x 1	200
MSRNZP316114	3/16 x 1 1/4	200
MSRNZP316112	3/16 x 1 1/2	200
MSRNZP316134	3/16 x 1 3/4	200
MSRNZP3162	3/16 x 2	200
MSRNZP316212	3/16 x 2 1/2	200
MSRNZP3163	3/16 x 3	200

1/4		Qty
MSRNZP1414	1/4 x 1/4	200
MSRNZP1438	1/4 x 3/8	200
MSRNZP1412	1/4 x 1/2	200
MSRNZP1458	1/4 x 5/8	200
MSRNZP1434	1/4 x 3/4	200
MSRNZP141	1/4 x 1	200
MSRNZP14114	1/4 x 1 1/4	200
MSRNZP14112	1/4 x 1 1/2	200
MSRNZP14134	1/4 x 1 3/4	200
MSRNZP142	1/4 x 2	200
MSRNZP14212	1/4 x 2 1/2	100
MSRNZP143	1/4 x 3	100

5/16		Qty
MSRNZP51612	5/16 x 1/2	200
MSRNZP51658	5/16 x 5/8	200
MSRNZP51634	5/16 x 3/4	200
MSRNZP5161	5/16 x 1	200
MSRNZP516114	5/16 x 1 1/4	200
MSRNZP516112	5/16 x 1 1/2	200
MSRNZP5162	5/16 x 2	200
MSRNZP516212	5/16 x 2 1/2	100
MSRNZP5163	5/16 x 3	100

**Mush Nib (Paint Scraper)
PHILLIPS/SLOT
STEEL - METRIC
STEEL - IMPERIAL
ZINC PLATED**



M 5		Qty
MSMNZP512	5 x 12	200
MSMNZP525	5 x 25	200

3/16		Qty
MSMNZP31614	3/16 x 1/4	200
MSMNZP31638	3/16 x 3/8	200
MSMNZP31612	3/16 x 1/2	200
MSMNZP31658	3/16 x 5/8	200
MSMNZP31634	3/16 x 3/4	200

SEMS ASSEMBLY SCREW

Complete with captive Flat & Spring Washers

Category 5

Pan 6-Lobe

Pan Phillips



Plating / Material:

Zinc Clear

Specifications:

JIS B1188

SEMS ASSEMBLY SCREW - Category 5

Pan Head
6-LOBE SEMS
STEEL - METRIC
ZINC PLATED
Complete with captive flat & spring washers



M 3		Qty
MSPTSZP36	3 x 6	200
MSPTSZP38	3 x 8	200
MSPTSZP310	3 x 10	200
MSPTSZP312	3 x 12	200

M 4		Qty
MSPTSZP48	4 x 8	200
MSPTSZP410	4 x 10	200
MSPTSZP412	4 x 12	200
MSPTSZP416	4 x 16	200
MSPTSZP420	4 x 20	200

Pan Head
PHILLIPS SEMS
STEEL - METRIC
ZINC PLATED
Complete with captive flat & spring washers



M 3		Qty
MSPPSZP36	3 x 6	200
MSPPSZP38	3 x 8	200
MSPPSZP310	3 x 10	200
MSPPSZP312	3 x 12	200

M 4		Qty
MSPPSZP48	4 x 8	200
MSPPSZP410	4 x 10	200
MSPPSZP412	4 x 12	200
MSPPSZP416	4 x 16	200
MSPPSZP420	4 x 20	200

M 5		Qty
MSPPSZP510	M5 x 10	200
MSPPSZP512	M5 x 12	200
MSPPSZP516	M5 x 16	200
MSPPSZP520	M5 x 20	200
MSPPSZP525	M5 x 25	200

M 6		Qty
MSPPSZP610	M6 x 10	200
MSPPSZP612	M6 x 12	200
MSPPSZP616	M6 x 16	200
MSPPSZP620	M6 x 20	200
MSPPSZP625	M6 x 25	200
MSPPSZP630	M6 x 30	200

SOLID STEEL RIVETS

Category 6

Round Head



Mush Head



25

25

SOLID STEEL RIVETS- Category 6

Round Head SOLID STEEL - IMPERIAL UNPLATED



1/8		Qty
MSRSRP1812	1/8 x 1/2	200
MSRSRP1834	1/8 x 3/4	200
MSRSRP181	1/8 x 1	200

5/32		Qty
MSRSRP53238	5/32 x 3/8	200
MSRSRP53212	5/32 x 1/2	200
MSRSRP53234	5/32 x 3/4	200
MSRSRP5321	5/32 x 1	200

3/16		Qty
MSRSRP31638	3/16 x 3/8	200
MSRSRP31612	3/16 x 1/2	200
MSRSRP31634	3/16 x 3/4	200
MSRSRP3161	3/16 x 1	200

1/4		Qty
MSRSRP1412	1/4 x 1/2	200
MSRSRP1434	1/4 x 3/4	200
MSRSRP141	1/4 x 1	200

Mush Head SOLID STEEL - IMPERIAL UNPLATED



1/4		Qty
MSMSRP1412	1/4 x 1/2	200
MSMSRP1434	1/4 x 3/4	200
MSMSRP141	1/4 x 1	200

Plating / Material:

Steel (no plating)

Specifications:

Steel: AS B118

THREAD ROLLING SCREWS

Steel Zinc & Waxed

Category 7

Hi-Tite (for metal)

Pan 6-Lobe



27

Pan Pozi

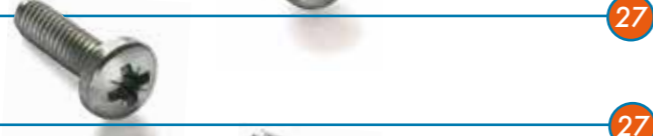

27

Countersunk Undercut



28

Countersunk Ribbed

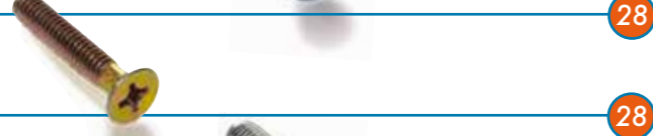

28

Indent Hex Washer Head



28

Hi-Plas (for plastics)

Pan 6-Lobe



29

Pan Pozi



30

Plating / Material:

Steel Zinc & Waxed

Specifications:

Steel: DIN 7500

THREAD ROLLING SCREWS - Category 7

**Pan Head
6-LOBE HI-TITE
STEEL - METRIC
FOR METAL
ZINC PLATED Thread
Rolling Screws - Waxed**



M 3			Qty
MSPTHZP36	3 x 6	1,000	
MSPTHZP38	3 x 8	1,000	
MSPTHZP310	3 x 10	1,000	
MSPTHZP312	3 x 12	1,000	
MSPTHZP314	3 x 14	1,000	

M 5			Qty
MSPTHZP510	5 x 10	1,000	
MSPTHZP512	5 x 12	1,000	
MSPTHZP516	5 x 16	1,000	
MSPTHZP520	5 x 20	1,000	

M 6			Qty
MSPTHZP610	6 x 10	1,000	
MSPTHZP612	6 x 12	1,000	
MSPTHZP616	6 x 16	1,000	
MSPTHZP620	6 x 20	1,000	
MSPTHZP630	6 x 30	1,000	

M 4			Qty
MSPTHZP48	4 x 8	1,000	
MSPTHZP410	4 x 10	1,000	
MSPTHZP412	4 x 12	1,000	
MSPTHZP416	4 x 16	1,000	
MSPTHZP420	4 x 20	1,000	

**Pan Head
POZI HI-TITE
STEEL - METRIC
FOR METAL
ZINC PLATED Thread
Rolling Screws - Waxed**



M 3			Qty
MSPZHZP36	3 x 6	1,000	
MSPZHZP38	3 x 8	1,000	
MSPZHZP312	3 x 12	1,000	

M 5			Qty
MSPZHZP510	5 x 10	1,000	
MSPZHZP512	5 x 12	1,000	
MSPZHZP516	5 x 16	1,000	
MSPZHZP520	5 x 20	1,000	

M 6			Qty
MSPZHZP612	6 x 12	1,000	
MSPZHZP616	6 x 16	1,000	
MSPZHZP620	6 x 20	1,000	
MSPZHZP625	6 x 25	1,000	

M 4			Qty
MSPZHZP48	4 x 8	1,000	
MSPZHZP410	4 x 10	1,000	
MSPZHZP412	4 x 12	1,000	
MSPZHZP416	4 x 16	1,000	
MSPZHZP420	4 x 20	1,000	

THREAD ROLLING SCREWS - Category 7

Countersunk Phillips
HI-TITE STEEL
FOR METAL
YELLOW ZINC PLATED
Thread Rolling Screws -
Waxed - RIBBED



M 6		Qty
MSCPHYP14112	14# x 1 1/2 (M6 x 38mm)	500

Countersunk Phillips
UNDERCUT HI-TITE
STEEL - METRIC
FOR METAL
ZINC PLATED Thread
Rolling Screws - Waxed



M 5		Qty
MSCUTZP512	5 x 12	1,000

Indent Hexagonal
Washer Head
HI-TITE STEEL - METRIC
FOR METAL
ZINC PLATED Thread
Rolling Screws - Waxed



M 6		Qty
MSIHWHP616	M6 x 16	1,000

M 8		Qty
MSIHWHP816	M8 x 16	200
MSIHWHP820	M8 x 20	200
MSIHWHP830	M8 x 30	200
MSIHWHP840	M8 x 40	200
MSIHWHP850	M8 x 50	200

M 10		Qty
MSIHWHP1020	M10 x 20	200
MSIHWHP1030	M10 x 30	200
MSIHWHP1040	M10 x 40	200
MSIHWHP1050	M10 x 50	200

M 12		Qty
MSIHWHP1230	M12 x 30	200

HI-TITE TRILOBULAR Thread Rolling Screws -
Recommended pilot hole sizes for various METAL thicknesses

Nominal Size	Material thickness mm	Pilot hole mm	Drill size mm	Material thickness mm	Pilot hole mm	Drill size mm	Material thickness mm	Pilot hole mm	Drill size mm	Material thickness mm	Pilot hole mm	Drill size mm	Material thickness mm	Pilot hole mm	Drill size mm
M3 x 0.5	0.5-1.1	2.71	No 36 2.71	1.1-1.7	2.72	No 36 2.71	1.7-2.17	2.74	2.75	2.75-3.3	2.76	2.75	3.3-4.0	2.77	7/64" 2.78
M4 x 0.7	0.8-1.4	3.59	3.6	1.4-2.4	3.61	3.6	2.4-3.3	3.64	No 27 3.66	3.3-4.4	3.66	No 27 3.66	4.4-5.5	3.68	3.7
M5 x 0.8	1.0-2.1	4.53	4.5	2.1-2.9	4.56	No 15 4.57	2.9-4.4	4.58	No 15 4.57	4.4-5.9	4.61	4.6	5.9-7.1	4.6	No 14 4.62
M6 x 1.0	1.2-2.4	5.42	No 3 5.41	2.4-3.6	5.45	No 3 5.41	3.6-4.9	5.48	5.5	4.9-6.9	5.51	5.5	6.9-8.1	5.55	7/32" 5.56
M8 x 1.25	2.5-3.5	7.30		4.0-5.5	7.35		6.0-7.5	7.35		>8-<12	7.40				
M10 x 1.5	2.5-3.5	9.20		4.0-7.0	9.30		7.5-10	9.40		>10-<15	9.50				
M12 x 1.75	2.4-4.9	10.98	11.0	4.9-7.4	11.03	11.0	7.4-10.5	11.09	7/16" 11.11	10.5-14.5	11.5	7/16" 11.11	14.5-17.0	11.2	7/16" 11.11

THREAD ROLLING SCREWS - Category 7

Indent Hexagonal
Washer Head
HI-TITE STEEL - METRIC
FOR METAL
MECHANICALLY
GALVANISED



M 10		Qty
MSIHWHP1020	M10 x 20	200
MSIHWHP1030	M10 x 30	200
MSIHWHP1040	M10 x 40	200
MSIHWHP1050	M10 x 50	200

M 12		Qty
MSIHWHP1230	M12 x 30	200

Pan Head
6-LOBE HI-PLAS
STEEL - METRIC
FOR PLASTICS
ZINC PLATED Thread
Rolling Screws - Waxed



M 4		Qty
MSPTPZP412	4 x 12	1,000

M 5		Qty
MSPTPZP520	5 x 20	1,000

HI-PLAS TRILOBULAR Thread Rolling Screws -
Recommended pilot hole sizes for various PLASTIC thicknesses

Nominal Size	MATERIAL THICKNESS							
	0.8	1.0	1.2	1.6	2.0	2.6	3.2	4.0
M2.5	2.10	2.10	2.10	2.10	2.15	2.15	2.15	2.15
M3	2.50	2.50	2.50	2.50	2.60	2.60	2.60	2.60
M4	3.44	3.44	3.44	3.44	3.55	3.55	3.55	3.55
M5	4.37	4.37	4.37	4.37	4.45	4.45	4.45	4.45
M6	5.26	5.26	5.26	5.26	5.35	5.35	5.35	5.35

All table measurements are in mm

SELF TAPPING SCREWS - Category 7

Pan Head
POZI HI-PLAS
STEEL - METRIC
FOR PLASTICS
 ZINC PLATED Thread
 Rolling Screws - Waxed



M 2.5		Qty
MSPZPZP256	2.5 x 6	1,000
MSPZPZP258	2.5 x 8	1,000
MSPZPZP2510	2.5 x 10	1,000
MSPZPZP2512	2.5 x 12	1,000

M 3		Qty
MSPZPZP36	3 x 6	1,000
MSPZPZP38	3 x 8	1,000
MSPZPZP310	3 x 10	1,000
MSPZPZP312	3 x 12	1,000

M 4		Qty
MSPZPZP48	4 x 8	1,000
MSPZPZP410	4 x 10	1,000
MSPZPZP412	4 x 12	1,000
MSPZPZP416	4 x 16	1,000
MSPZPZP420	4 x 20	1,000

M 5		Qty
MSPZPZP510	5 x 10	1,000
MSPZPZP512	5 x 12	1,000
MSPZPZP516	5 x 16	1,000
MSPZPZP520	5 x 20	1,000

M 6		Qty
MSPZPZP612	6 x 12	1,000
MSPZPZP616	6 x 16	1,000
MSPZPZP620	6 x 20	1,000
MSPZPZP625	6 x 25	1,000

SELF TAPPING SCREWS Type AB

Category 8

Pan Phillips

Pan Square/Phillips Combination

Countersunk Phillips

Countersunk Square/Phillips Combination

Flange Head Phillips (Automotive)

Assortment Kits

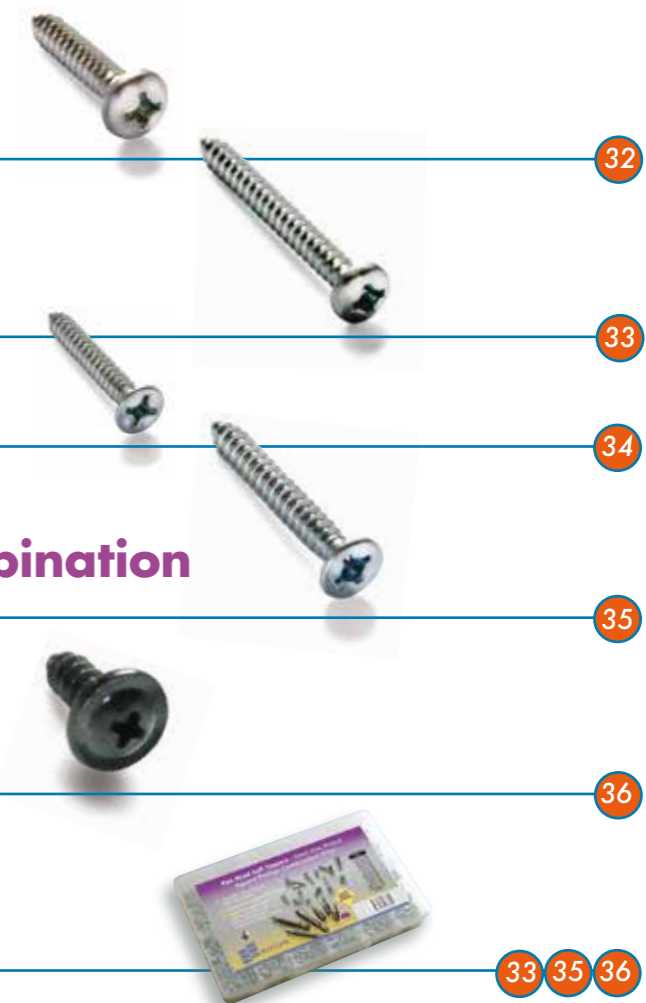

Plating / Material:

Zinc Clear
 Black Zinc
 Mechanically Galvanised

Specifications:

Pan & Csk: ANSI B 18.6.4
 Flange: AS B194

SELF TAPPING SCREWS - Category 8

Pan Head PHILLIPS STEEL - IMPERIAL ZINC PLATED



2#		Qty
MSPPTZP214	2# x 1/4	1,000
MSPPTZP238	2# x 3/8	1,000
MSPPTZP212	2# x 1/2	1,000

4#		Qty
MSPPTZP414	4# x 1/4	1,000
MSPPTZP438	4# x 3/8	1,000
MSPPTZP412	4# x 1/2	1,000
MSPPTZP458	4# x 5/8	1,000
MSPPTZP434	4# x 3/4	1,000
MSPPTZP41	4# x 1	1,000

6#		Qty
MSPPTZP614	6# x 1/4	1,000
MSPPTZP638	6# x 3/8	1,000
MSPPTZP612	6# x 1/2	1,000
MSPPTZP658	6# x 5/8	1,000
MSPPTZP634	6# x 3/4	1,000
MSPPTZP61	6# x 1	1,000
MSPPTZP6114	6# x 1 1/4	1,000
MSPPTZP6112	6# x 1 1/2	1,000
MSPPTZP62	6# x 2	1,000

8#		Qty
MSPPTZP838	8# x 3/8	1,000
MSPPTZP812	8# x 1/2	1,000
MSPPTZP858	8# x 5/8	1,000
MSPPTZP834	8# x 3/4	1,000
MSPPTZP81	8# x 1	1,000
MSPPTZP8114	8# x 1 1/4	1,000
MSPPTZP8112	8# x 1 1/2	1,000
MSPPTZP8134	8# x 1 3/4	1,000
MSPPTZP82	8# x 2	1,000

10#		Qty
MSPPTZP1038	10# x 3/8	1,000
MSPPTZP1012	10# x 1/2	1,000
MSPPTZP1058	10# x 5/8	1,000
MSPPTZP1034	10# x 3/4	1,000
MSPPTZP101	10# x 1	1,000
MSPPTZP10114	10# x 1 1/4	1,000
MSPPTZP10112	10# x 1 1/2	1,000
MSPPTZP10134	10# x 1 3/4	1,000
MSPPTZP102	10# x 2	1,000
MSPPTZP10212	10# x 2 1/2	500
MSPPTZP103	10# x 3	500

12#		Qty
MSPPTZP1212	12# x 1/2	1,000
MSPPTZP1258	12# x 5/8	1,000
MSPPTZP1234	12# x 3/4	1,000
MSPPTZP121	12# x 1	1,000
MSPPTZP12114	12# x 1 1/4	1,000
MSPPTZP12112	12# x 1 1/2	1,000
MSPPTZP12134	12# x 1 3/4	1,000
MSPPTZP122	12# x 2	1,000
MSPPTZP12212	12# x 2 1/2	500
MSPPTZP123	12# x 3	500

14#		Qty
MSPPTZP1412	14# x 1/2	1,000
MSPPTZP1458	14# x 5/8	1,000
MSPPTZP1434	14# x 3/4	1,000
MSPPTZP141	14# x 1	1,000
MSPPTZP14114	14# x 1 1/4	1,000
MSPPTZP14112	14# x 1 1/2	1,000
MSPPTZP14134	14# x 1 3/4	1,000
MSPPTZP142	14# x 2	1,000
MSPPTZP14212	14# x 2 1/2	500
MSPPTZP143	14# x 3	500

Pan Head PHILLIPS STEEL - IMPERIAL MECHANICALLY GALVANISED (15um)



6#		Qty
MSPPTH638	6# x 3/8	1,000
MSPPTH612	6# x 1/2	1,000
MSPPTH634	6# x 3/4	1,000
MSPPTH61	6# x 1	1,000

8#		Qty
MSPPTH838	8# x 3/8	1,000
MSPPTH812	8# x 1/2	1,000
MSPPTH834	8# x 3/4	1,000
MSPPTH81	8# x 1	1,000

10#		Qty
MSPPTH101	10# x 1	1,000

SELF TAPPING SCREWS - Category 8

Pan Head SQUARE/PHILLIPS COMBINATION STEEL - IMPERIAL ZINC PLATED



4#		Qty
MSPCTZP414	4# x 1/4	1,000
MSPCTZP438	4# x 3/8	1,000
MSPCTZP412	4# x 1/2	1,000
MSPCTZP458	4# x 5/8	1,000
MSPCTZP434	4# x 3/4	1,000
MSPCTZP41	4# x 1	1,000

6#		Qty
MSPCTZP614	6# x 1/4	1,000
MSPCTZP638	6# x 3/8	1,000
MSPCTZP612	6# x 1/2	1,000
MSPCTZP658	6# x 5/8	1,000
MSPCTZP634	6# x 3/4	1,000
MSPCTZP61	6# x 1	1,000
MSPCTZP6114	6# x 1 1/4	1,000
MSPCTZP6112	6# x 1 1/2	1,000

8#		Qty
MSPCTZP838	8# x 3/8	1,000
MSPCTZP812	8# x 1/2	1,000
MSPCTZP858	8# x 5/8	1,000
MSPCTZP834	8# x 3/4	1,000
MSPCTZP81	8# x 1	1,000
MSPCTZP8114	8# x 1 1/4	1,000
MSPCTZP8112	8# x 1 1/2	1,000
MSPCTZP8134	8# x 1 3/4	1,000
MSPCTZP82	8# x 2	1,000

10#		Qty
MSPCTZP1038	10# x 3/8	1,000
MSPCTZP1012	10# x 1/2	1,000
MSPCTZP1058	10# x 5/8	1,000
MSPCTZP1034	10# x 3/4	1,000
MSPCTZP101	10# x 1	1,000
MSPCTZP10114	10# x 1 1/4	1,000
MSPCTZP10112	10# x 1 1/2	1,000
MSPCTZP10134	10# x 1 3/4	1,000
MSPCTZP102	10# x 2	1,000

12#		Qty
MSPCTZP1212	12# x 1/2	1,000
MSPCTZP1258	12# x 5/8	1,000
MSPCTZP1234	12# x 3/4	1,000
MSPCTZP121	12# x 1	1,000
MSPCTZP12114	12# x 1 1/4	1,000
MSPCTZP12112	12# x 1 1/2	1,000
MSPCTZP12134	12# x 1 3/4	1,000
MSPCTZP122	12# x 2	1,000

14#		Qty
MSPCTZP1412	14# x 1/2	1,000
MSPCTZP1458	14# x 5/8	1,000
MSPCTZP1434	14# x 3/4	1,000
MSPCTZP141	14# x 1	1,000
MSPCTZP14114	14# x 1 1/4	1,000
MSPCTZP14112	14# x 1 1/2	1,000
MSPCTZP142	14# x 2	1,000

Pan Combination SQUARE/PHILLIPS Self Tapper Grab Kit ASSORTMENT PACK ZINC PLATED 4 to 10 Gauge Diameters

SELF TAPPER KIT		Qty
STPANKIT12	12 Sizes	2,400



SELF TAPPING SCREWS - Category 8

Countersunk Head PHILLIPS STEEL - IMPERIAL ZINC PLATED



4#		Qty
MSCPTZP414	4# x 1/4	1,000
MSCPTZP438	4# x 3/8	1,000
MSCPTZP412	4# x 1/2	1,000
MSCPTZP458	4# x 5/8	1,000
MSCPTZP434	4# x 3/4	1,000
MSCPTZP41	4# x 1	1,000
5#		
MSCPTZP512	5# x 1/2	1,000
MSCPTZP558	5# x 5/8	1,000
MSCPTZP534	5# x 3/4	1,000
MSCPTZP51	5# x 1	1,000
6#		
MSCPTZP638	6# x 3/8	1,000
MSCPTZP612	6# x 1/2	1,000
MSCPTZP658	6# x 5/8	1,000
MSCPTZP634	6# x 3/4	1,000
MSCPTZP61	6# x 1	1,000
MSCPTZP6114	6# x 1 1/4	1,000
MSCPTZP6112	6# x 1 1/2	1,000

8#		Qty
MSCPTZP838	8# x 3/8	1,000
MSCPTZP812	8# x 1/2	1,000
MSCPTZP858	8# x 5/8	1,000
MSCPTZP834	8# x 3/4	1,000
MSCPTZP81	8# x 1	1,000
MSCPTZP8114	8# x 1 1/4	1,000
MSCPTZP8112	8# x 1 1/2	1,000
MSCPTZP8134	8# x 1 3/4	1,000
MSCPTZP82	8# x 2	1,000

10#		Qty
MSCPTZP1038	10# x 3/8	1,000
MSCPTZP1012	10# x 1/2	1,000
MSCPTZP1058	10# x 5/8	1,000
MSCPTZP1034	10# x 3/4	1,000
MSCPTZP101	10# x 1	1,000
MSCPTZP10114	10# x 1 1/4	1,000
MSCPTZP10112	10# x 1 1/2	1,000
MSCPTZP10134	10# x 1 3/4	1,000
MSCPTZP102	10# x 2	1,000
MSCPTZP10212	10# x 2 1/2	500
MSCPTZP103	10# x 3	500

12#		Qty
MSCPTZP1258	12# x 5/8	1,000
MSCPTZP1234	12# x 3/4	1,000
MSCPTZP121	12# x 1	1,000
MSCPTZP12114	12# x 1 1/4	1,000
MSCPTZP12112	12# x 1 1/2	1,000
MSCPTZP12134	12# x 1 3/4	1,000
MSCPTZP122	12# x 2	1,000
MSCPTZP12212	12# x 2 1/2	500
MSCPTZP123	12# x 3	500

14#		Qty
MSCPTZP1412	14# x 1/2	1,000
MSCPTZP1458	14# x 5/8	1,000
MSCPTZP1434	14# x 3/4	1,000
MSCPTZP141	14# x 1	1,000
MSCPTZP14114	14# x 1 1/4	1,000
MSCPTZP14112	14# x 1 1/2	1,000
MSCPTZP14134	14# x 1 3/4	1,000
MSCPTZP142	14# x 2	1,000
MSCPTZP14212	14# x 2 1/2	500
MSCPTZP143	14# x 3	500

Countersunk Head PHILLIPS STEEL - IMPERIAL MECHANICALLY GALVANISED (15um)



8#		Qty
MSCPTHP834	8# x 3/4	1,000

SELF TAPPING SCREWS - Category 8

Countersunk Head SQUARE/PHILLIPS COMBINATION STEEL - IMPERIAL ZINC PLATED



4#		Qty
MSCCTZP414	4# x 1/4	1,000
MSCCTZP438	4# x 3/8	1,000
MSCCTZP412	4# x 1/2	1,000
MSCCTZP458	4# x 5/8	1,000
MSCCTZP434	4# x 3/4	1,000
MSCCTZP41	4# x 1	1,000
5#		
MSCCTZP558	5# x 5/8	1,000
MSCCTZP534	5# x 3/4	1,000
6#		
MSCCTZP638	6# x 3/8	1,000
MSCCTZP612	6# x 1/2	1,000
MSCCTZP658	6# x 5/8	1,000
MSCCTZP634	6# x 3/4	1,000
MSCCTZP61	6# x 1	1,000
MSCCTZP6114	6# x 1 1/4	1,000
MSCCTZP6112	6# x 1 1/2	1,000

8#		Qty
MSCCTZP838	8# x 3/8	1,000
MSCCTZP812	8# x 1/2	1,000
MSCCTZP858	8# x 5/8	1,000
MSCCTZP834	8# x 3/4	1,000
MSCCTZP81	8# x 1	1,000
MSCCTZP8114	8# x 1 1/4	1,000
MSCCTZP8112	8# x 1 1/2	1,000
MSCCTZP8134	8# x 1 3/4	1,000
MSCCTZP82	8# x 2	1,000
10#		
MSCCTZP1012	10# x 1/2	1,000
MSCCTZP1058	10# x 5/8	1,000
MSCCTZP1034	10# x 3/4	1,000
MSCCTZP101	10# x 1	1,000
MSCCTZP10114	10# x 1 1/4	1,000
MSCCTZP10112	10# x 1 1/2	1,000
MSCCTZP10134	10# x 1 3/4	1,000
MSCCTZP102	10# x 2	1,000

12#		Qty
MSCCTZP1258	12# x 5/8	1,000
MSCCTZP1234	12# x 3/4	1,000
MSCCTZP121	12# x 1	1,000
MSCCTZP12114	12# x 1 1/4	1,000
MSCCTZP12112	12# x 1 1/2	1,000
MSCCTZP12134	12# x 1 3/4	1,000
MSCCTZP122	12# x 2	1,000
14#		
MSCCTZP1412	14# x 1/2	1,000
MSCCTZP1458	14# x 5/8	1,000
MSCCTZP1434	14# x 3/4	1,000
MSCCTZP141	14# x 1	1,000
MSCCTZP14114	14# x 1 1/4	1,000
MSCCTZP14112	14# x 1 1/2	1,000
MSCCTZP142	14# x 2	1,000

Countersunk Combination SQUARE/PHILLIPS Self Tapper Grab Kit ASSORTMENT PACK ZINC PLATED 4 to 10 Gauge Diameters

SELF TAPPER KIT	Qty
STCSKIT12	12 Sizes 2,400

Pan and Countersunk ASSORTMENT PACK Self Tapper Grab Kit ASSORTMENT PACK ZINC PLATED 4 to 10 Gauge Diameters

SELF TAPPER KIT	Qty
STKIT24	24 Sizes 4,800



SELF TAPPING SCREWS - Category 8

**Pan Head
PHILLIPS
STEEL - IMPERIAL
BLACK ZINC PLATED**



4#		Qty
MSPPTBZP438	4# x 3/8	1,000
MSPPTBZP412	4# x 1/2	1,000
6#		
MSPPTBZP638	6# x 3/8	1,000
MSPPTBZP612	6# x 1/2	1,000
MSPPTBZP658	6# x 5/8	1,000
MSPPTBZP634	6# x 3/4	1,000
MSPPTBZP61	6# x 1	1,000

**Countersunk Head
PHILLIPS
STEEL - IMPERIAL
BLACK ZINC PLATED**

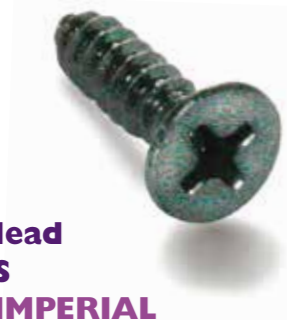

6#		Qty
MSCPTBZP638	6# x 3/8	1,000
MSCPTBZP658	6# x 5/8	1,000
MSCPTBZP612	6# x 1/2	1,000
MSCPTBZP634	6# x 3/4	1,000

**Flange Head
PHILLIPS
STEEL - IMPERIAL
BLACK ZINC PLATED
AUTOMOTIVE SCREW**



6#		Qty
MSFPBZP638	6# x 3/8	1,000
MSFPBZP612	6# x 1/2	1,000
MSFPBZP634	6# x 3/4	1,000
8#		
MSFPBZP838	8# x 3/8	1,000
MSFPBZP812	8# x 1/2	1,000
MSFPBZP834	8# x 3/4	1,000
MSFPBZP81	8# x 1	1,000
MSFPBZP8112	8# x 1 1/2	1,000

**Flange Head
PHILLIPS
Automotive Self
Tapper Grab Kit
ASSORTMENT PACK
BLACK ZINC PLATED**



8#		Qty
MSPPTBZP838	8# x 3/8	1,000
MSPPTBZP812	8# x 1/2	1,000
MSPPTBZP858	8# x 5/8	1,000
MSPPTBZP834	8# x 3/4	1,000
MSPPTBZP81	8# x 1	1,000
MSPPTBZP8114	8# x 1 1/4	1,000
MSPPTBZP8112	8# x 1 1/2	1,000
10#		
MSPPTBZP1034	10# x 3/4	1,000
MSPPTBZP101	10# x 1	1,000
MSPPTBZP10114	10# x 1 1/4	1,000

8#		Qty
MSCPTBZP812	8# x 1/2	1,000
MSCPTBZP858	8# x 5/8	1,000
MSCPTBZP834	8# x 3/4	1,000

10#		Qty
MSFPBZP1012	10# x 1/2	1,000
MSFPBZP1034	10# x 3/4	1,000
MSFPBZP101	10# x 1	1,000
MSFPBZP10112	10# x 1 1/2	1,000
MSFPBZP102	10# x 2	1,000

www.hitechfasteners.com.au

INDEX

Category 9

NUTS Metric, Imperial, Unified & B.A

**Cold Formed Hexagon -
Metric, Imperial, Unified & B.A
Steel Zinc & Brass**



38

**Square Pressed Nuts
Steel Zinc**



40

**Dome Nuts
Chrome & Galvanised**



41

**Wing Nuts
Steel Zinc, Brass
& Galvanised**



42

**Tee Nuts - 4 Prong
Steel Zinc**



43

Specifications:

Metric Hex Standard Nut:	AS 1112
Imperial Hex Standard Nut:	1/8-3/16 AS B50
Imperial Hex Standard Nut:	1/4-1/2 AS 2451
Unified:	ANSI B 18.6.3
B.A.:	BS 57
Pressed Nuts:	Metric - Refer Chart on page 39
Pressed Nuts:	Imperial - Refer Chart on page 39
Dome Nuts:	Metric DIN 1587
Dome Nuts:	Imperial ANSI Standard
Wing Nuts:	Metric UNI 5448
Wing Nuts:	Imperial ANSI B 18.17

INDEX

NUTS - Category 9

Hexagonal Nut
COLD FORMED
STEEL - METRIC
ZINC PLATED



M 1.6		Qty
MSHNZB16	M1.6	10,000
MSHNZP16	M1.6	200

M 2		Qty
MSHNZB2	M2	10,000
MSHNZP2	M2	200

M 2.5		Qty
MSHNZB25	M2.5	10,000
MSHNZP25	M2.5	200

M 3		Qty
MSHNZB3	M3	10,000
MSHNZP3	M3	200

M 3.5		Qty
MSHNZB35	M3.5	10,000
MSHNZP35	M3.5	200

M 4		Qty
MSHNZB4	M4	10,000
MSHNZP4	M4	200

M 5		Qty
MSHNZB5	M5	9,000
MSHNZP5	M5	200

M 6		Qty
MSHNZB6	M6	5,000
MSHNZP6	M6	200

M 8		Qty
MSHNZB8	M8	3,000
MSHNZP8	M8	200

M 10		Qty
MSHNZB10	M10	2,000
MSHNZP10	M10	200

M 12		Qty
MSHNZB12M	M12	800
MSHNZP12M	M12	150

Hexagonal Nut
COLD FORMED
STEEL - METRIC
BLACK ZINC PLATED



M 3		Qty
MSHNBZP3	M3	200

M 4		Qty
MSHNBZP4	M4	200

M 5		Qty
MSHNBZP5	M5	200

M 6		Qty
MSHNBZP6	M6	200

Hexagonal Nut
COLD FORMED
STEEL BSW - IMPERIAL
ZINC PLATED



1/8		Qty
MSHNZB18	1/8	10,000
MSHNZP18	1/8	200

5/32		Qty
MSHNZB532	5/32	10,000
MSHNZP532	5/32	200

3/16		Qty
MSHNZB316	3/16	10,000
MSHNZP316	3/16	200

1/4		Qty
MSHNZB14	1/4	6,000
MSHNZP14	1/4	200

5/16		Qty
MSHNZB516	5/16	4,000
MSHNZP516	5/16	200

3/8		Qty
MSHNZB38	3/8	2,500
MSHNZP38	3/8	200

1/2 BSW		Qty
MSHNZB12	1/2	800
MSHNZP12	1/2	150

NUTS - Category 9

Hexagonal Nut
COLD FORMED
STEEL - UNIFIED
ZINC PLATED



2-56		Qty
MSHNZB256	2-56 UNC	1,000
MSHNZP256	2-56 UNC	200

4-40		Qty
MSHNZB440	4-40 UNC	1,000
MSHNZP440	4-40 UNC	200

6-32		Qty
MSHNZB632	6-32 UNC	1,000
MSHNZP632	6-32 UNC	200

8-32		Qty
MSHNZB832	8-32 UNC	1,000
MSHNZP832	8-32 UNC	200

10-32		Qty
MSHNZB1032	10-32 UNF	1,000
MSHNZP1032	10-32 UNF	200

Hexagonal Nut
COLD FORMED
STEEL - B.A
ZINC PLATED



6BA		Qty
MSHNZB6BA	6BA	1,000
MSHNZP6BA	6BA	200

4BA		Qty
MSHNZB4BA	4BA	1,000
MSHNZP4BA	4BA	200

2BA		Qty
MSHNZB2BA	2BA	1,000
MSHNZP2BA	2BA	200

Hexagonal Nut
COLD FORMED
BRASS - METRIC



M 2.5		Qty
BRHNB25	M2.5	1,000
BRHNP25	M2.5	200

M 3		Qty
BRHNB3	M3	1,000
BRHNP3	M3	200

M 4		Qty
BRHNB4	M4	1,000
BRHNP4	M4	200

M 5		Qty
BRHNB5	M5	1,000
BRHNP5	M5	200

M 6		Qty
BRHNB6	M6	1,000
BRHNP6	M6	200

M 8		Qty
BRHNP8	M8	50

M 10		Qty
BRHNP10	M10	50

M 12		Qty
BRHNP12M	M12	50

NUTS - Category 9

Hexagonal Nut COLD FORMED BRASS - BSW IMPERIAL



1/8		Qty
BRHNB18	1/8	1,000
BRHNP18	1/8	200
5/32		
BRHNB532	5/32	1,000
BRHNP532	5/32	200

3/16		Qty
BRHNB316	3/16	1,000
BRHNP316	3/16	200
1/4		
BRHNB14	1/4	1,000
BRHNP14	1/4	200

5/16		Qty
BRHNP516	5/16	50
3/8		
BRHNP38	3/8	50

Hexagonal Nut COLD FORMED BRASS - UNIFIED



1/2		Qty
BRHNC12	1/2 UNC	50

Hexagonal Nut COLD FORMED BRASS - B.A



6BA		Qty
BRHNB6BA	6BA	1,000
BRHNP6BA	6BA	200

4BA		Qty
BRHNB4BA	4BA	1,000
BRHNP4BA	4BA	200

2BA		Qty
BRHNB2BA	2BA	1,000
BRHNP2BA	2BA	200

Square PRESSED NUT STEEL - METRIC ZINC PLATED

For Nut dimensions,
see page 39



M 3		Qty
MSSPNZB3	M3	1,000
MSSPNZP3	M3	200
M 4		
MSSPNZB4	M4	1,000
MSSPNZP4	M4	200

M 5		Qty
MSSPNZB5	M5	1,000
MSSPNZP5	M5	200
M 6		
MSSPNZB6	M6	1,000
MSSPNZP6	M6	200

NUTS - Category 9

Square PRESSED NUT STEEL BSW - IMPERIAL ZINC PLATED



1/8		Qty
MSSPNZB18	1/8	1,000
MSSPNZP18	1/8	200
5/32		
MSSPNZB532	5/32	1,000
MSSPNZP532	5/32	200

3/16		Qty
MSSPNZB316	3/16	1,000
MSSPNZP316	3/16	200
1/4		
MSSPNZB14	1/4	1,000
MSSPNZP14	1/4	200

5/16		Qty
MSSPNZB516	5/16	1,000
MSSPNZP516	5/16	200

SQUARE PRESSED NUT DIMENSION TABLE

DIA.	MAXIMUM	A/F	MINIMUM	THICK (Max)	DIA.	MAXIMUM	A/F	MINIMUM	THICK (Max)
M3	5.5		5.32	1.8	1/8	5.58		5.28	2.12
M4	7.0		6.78	2.2	5/32	7.15		6.79	2.73
M5	8.0		7.78	2.7	3/16	8.20		7.83	3.00
M6	10.0		9.78	3.2	1/4	11.0		10.57	3.00
					5/16	14.20		13.80	5.60

Dome Nut MILD STEEL METRIC CHROME PLATED



M 3		Qty
MSDNCP3	M3(5.5 A/F)	200
M 4		
MSDNCP4	M4(7.0 A/F)	200
M 5		
MSDNCP5	M5(8.0 A/F)	200
M 6		
MSDNCP6	M6(10.0 A/F)	200

M 8		Qty
MSDNCP8	M8(13.0 A/F)	200
M 10		
MSDNCP10	M10(17.0 A/F)	100
M 12		
MSDNCP12M	M12(19.0 A/F)	100
M 16		
MSDNCP16	M16(24.0 A/F)	25

M 20		Qty
MSDNCP20	M20(30.0 A/F)	25
M 24		
MSDNCP24	M24(36.0 A/F)	20

Dome Nut MILD STEEL IMPERIAL CHROME PLATED



5/32		Qty
MSDNCP532	5/32 (5/16 A/F)	200
3/16		
MSDNCP316	3/16 (3/8 A/F)	200

1/4		Qty
MSDNCP14	1/4 (7/16 A/F)	200
5/16		
MSDNCP516	5/16 (9/16 A/F)	200

3/8		Qty
MSDNCP38	3/8 (5/8 A/F)	100
1/2 BSW		
MSDNCP12	1/2BSW (3/4 A/F)	100

NUTS - Category 9

Dome Nut
MILD STEEL
 Thread Tapped Oversize
METRIC
 HOT DIPPED GALVANISED



M 8	Qty
MSDNGP8 M8 (13.0 A/F)	200
M 10	Qty
MSDNGP10 M10 (17.0 A/F)	100
M 12	Qty
MSDNGP12M M12 (19.0 A/F)	100

M 16	Qty
MSDNGP16 M16 (24.0 A/F)	25
M 20	Qty
MSDNGP20 M20 (30.0 A/F)	25
M 24	Qty
MSDNGP24 M24 (36.0 A/F)	20

M 30	Qty
MSDNGP30 M30 (46.0 A/F)	10
M 36	Qty
MSDNGP36 M36 (55.0 A/F)	5

Wing Nut
COLD FORMED STEEL
METRIC
 ZINC PLATED



M 3	Qty
MSWNZB3 M3	1,000
MSWNZP3 M3	200
M 4	Qty
MSWNZB4 M4	1,000
MSWNZP4 M4	200
M 5	Qty
MSWNZB5 M5	1,000
MSWNZP5 M5	200

M 6	Qty
MSWNZB6 M6	1,000
MSWNZP6 M6	200
M 8	Qty
MSWNZB8 M8	1,000
MSWNZP8 M8	200
M 10	Qty
MSWNZP10 M10	200

M 12	Qty
MSWNZP12M M12	200
M 16	Qty
MSWNZP16 M16	25
M 20	Qty
MSWNZP20 M20	25

Wing Nut
COLD FORMED STEEL
IMPERIAL
 ZINC PLATED



1/8	Qty
MSWNZB18 1/8	1,000
MSWNZP18 1/8	200
5/32	Qty
MSWNZB532 5/32	1,000
MSWNZP532 5/32	200

3/16	Qty
MSWNZB316 3/16	1,000
MSWNZP316 3/16	200
1/4	Qty
MSWNZB14 1/4	1,000
MSWNZP14 1/4	200

5/16	Qty
MSWNZB516 5/16	1,000
MSWNZP516 5/16	200
3/8	Qty
MSWNZP38 3/8	200
1/2 BSW	Qty
MSWNZP12 1/2	200

Wing Nut
MILD STEEL
METRIC
 MECHANICALLY GALVANISED 15um



M 8	Qty
MSWNHP8 M8	200
M 10	Qty
MSWNHP10 M10	100
M 12	Qty
MSWNHP12M M12	100

M 16	Qty
MSWNHP16 M16	25

M 16	Qty
MSWNHP16 M16	25

NUTS - Category 9

Wing Nut
BRASS
METRIC



M 3	Qty
BRWNB3 M3	1,000
BRWNP3 M3	200
M 4	Qty
BRWNB4 M4	1,000
BRWNP4 M4	200

M 5	Qty
BRWNB5 M5	1,000
BRWNP5 M5	200
M 6	Qty
BRWNB6 M6	1,000
BRWNP6 M6	200

M 8	Qty
BRWNB8 M8	1,000
BRWNP8 M8	200
M 10	Qty
BRWNP10 M10	100
M 12	Qty
BRWNP12M M12	50

Wing Nut
BRASS
IMPERIAL



1/8	Qty
BRWNB18 1/8	1,000
BRWNP18 1/8	200
5/32	Qty
BRWNB532 5/32	1,000
BRWNP532 5/32	200

3/16	Qty
BRWNB316 3/16	1,000
BRWNP316 3/16	200
1/4	Qty
BRWNB14 1/4	1,000
BRWNP14 1/4	200

5/16	Qty
BRWNB516 5/16	1,000
BRWNP516 5/16	200
3/8	Qty
BRWNP38 3/8	100
1/2 BSW	Qty
BRWNP12 1/2	50

Tee Nuts - 4 Prong
MILD STEEL
METRIC
 For Wood
 ZINC PLATED



M 4	Qty
MSTNZP4 M4 x 15 x 7	200
M 5	Qty
MSTNZP5 M5 x 15 x 7	100

M 6	Qty
MSTNZP6 M6 x 18 x 7	200
M 8	Qty
MSTNZP89 M8 x 22 x 9	200
MSTNZP816 M8 x 22 x 16	200

M 10	Qty
MSTNZP10 M10 x 25 x 11	200

Tee Nuts - 4 Prong
MILD STEEL
IMPERIAL
 For Wood
 ZINC PLATED



3/16	Qty
MSTNZP316 3/16unc 18 x 7mm	200
1/4	Qty
MSTNZP14 1/4unc 18 x 7mm	200

5/16	Qty
MSTNZP5169 5/16unc 22 x 9mm	200
MSTNZP51616 5/16unc 22 x 16mm	200

3/8	Qty
MSTNZP38 3/8unc 25 x 11mm	200

THUMB & WING SCREWS

Steel Zinc Plated

Category 10

Thumb Screw



Wing Screw



45

46

Plating / Material:

Zinc Clear
Stainless Steel

Specifications:

Thumb Screws: Refer Drawing
Wing Screws: Refer Drawing

THUMB & WING SCREWS - Category 10

Thumb Screw
STEEL - METRIC
ZINC PLATED



M 5		Qty
MSTSZB512	5 x 12	1,000
MSTSZP512	5 x 12	200
MSTSZB516	5 x 16	1,000
MSTSZP516	5 x 16	200
MSTSZB520	5 x 20	1,000
MSTSZP520	5 x 20	200
MSTSZB525	5 x 25	1,000
MSTSZP525	5 x 25	200

M 6		Qty
MSTSZB612	6 x 12	1,000
MSTSZP612	6 x 12	200
MSTSZB616	6 x 16	1,000
MSTSZP616	6 x 16	200
MSTSZB620	6 x 20	1,000
MSTSZP620	6 x 20	200
MSTSZB625	6 x 25	1,000
MSTSZP625	6 x 25	200
MSTSZB640	6 x 40	1,000
MSTSZP640	6 x 40	200

M 8		Qty
MSTSZB820	8 x 20	1,000
MSTSZP820	8 x 20	200
MSTSZB825	8 x 25	1,000
MSTSZP825	8 x 25	200
MSTSZB830	8 x 30	1,000
MSTSZP830	8 x 30	200
MSTSZB840	8 x 40	1,000
MSTSZP840	8 x 40	200
MSTSZB850	8 x 50	1,000
MSTSZP850	8 x 50	200

Thumb Screw
STEEL - IMPERIAL
ZINC PLATED



3/16		Qty
MSTSZB31612	3/16 x 1/2	1,000
MSTSZP31612	3/16 x 1/2	200
MSTSZB31634	3/16 x 3/4	1,000
MSTSZP31634	3/16 x 3/4	200
MSTSZB3161	3/16 x 1	1,000
MSTSZP3161	3/16 x 1	200

1/4		Qty
MSTSZB1412	1/4 x 1/2	1,000
MSTSZP1412	1/4 x 1/2	200
MSTSZB1434	1/4 x 3/4	1,000
MSTSZP1434	1/4 x 3/4	200
MSTSZB141	1/4 x 1	1,000
MSTSZP141	1/4 x 1	200
MSTSZB14114	1/4 x 1 1/4	1,000
MSTSZP14114	1/4 x 1 1/4	200
MSTSZB14112	1/4 x 1 1/2	1,000
MSTSZP14112	1/4 x 1 1/2	200

5/16		Qty
MSTSZB51634	5/16 x 3/4	1,000
MSTSZP51634	5/16 x 3/4	200
MSTSZB5161	5/16 x 1	1,000
MSTSZP5161	5/16 x 1	200
MSTSZB516114	5/16 x 1 1/4	1,000
MSTSZP516114	5/16 x 1 1/4	200
MSTSZB516112	5/16 x 1 1/2	1,000
MSTSZP516112	5/16 x 1 1/2	200

Thumb Screw
Stainless Steel
Grade 304 - METRIC

M 6		Qty
S4TSP620	6 x 20	50



Thumb Screw
Stainless Steel
Grade 304 - IMPERIAL

5/16		Qty
S4TSP5161	5/16 x 1 UNC	50

THUMB & WING SCREWS - Category 10

Wing Screw
STEEL - METRIC
ZINC PLATED



M 3		Qty
MSWSZP310	M3 x 10	200
MSWSZP312	M3 x 12	200
MSWSZP315	M3 x 15	200

M 4		Qty
MSWSZP410	M4 x 10	200
MSWSZP412	M4 x 12	200
MSWSZP415	M4 x 15	200
MSWSZP420	M4 x 20	200

M 5		Qty
MSWSZP510	M5 x 10	200
MSWSZP512	M5 x 12	200
MSWSZP515	M5 x 15	200
MSWSZP520	M5 x 20	200
MSWSZP525	M5 x 25	200

M 6		Qty
MSWSZP610	M6 x 10	200
MSWSZP612	M6 x 12	200
MSWSZP615	M6 x 15	200
MSWSZP620	M6 x 20	200
MSWSZP625	M6 x 25	200
MSWSZP630	M6 x 30	200
MSWSZP640	M6 x 40	200

M 8		Qty
MSWSZP815	M8 x 15	100
MSWSZP820	M8 x 20	100
MSWSZP825	M8 x 25	100
MSWSZP830	M8 x 30	100
MSWSZP840	M8 x 40	100
MSWSZP850	M8 x 50	50

M 10		Qty
MSWSZP1020	M10 x 20	50
MSWSZP1025	M10 x 25	50
MSWSZP1030	M10 x 30	50
MSWSZP1040	M10 x 40	50
MSWSZP1050	M10 x 50	25

M 12		Qty
MSWSZP1220	M12 x 20	20
MSWSZP1225	M12 x 25	20
MSWSZP1230	M12 x 30	20
MSWSZP1240	M12 x 40	20
MSWSZP1250	M12 x 50	20

Wing Screw
Stainless Steel
Grade 304 -
METRIC



M 5		Qty
S4WSP516	M5 x 16	50
S4WSP520	M5 x 20	50
S4WSP525	M5 x 25	50

M 6		Qty
S4WSP612	M6 x 12	50
S4WSP616	M6 x 16	50
S4WSP620	M6 x 20	50
S4WSP625	M6 x 25	50
S4WSP630	M6 x 30	50

M 8		Qty
S4WSP820	M8 x 20	25
S4WSP825	M8 x 25	25
S4WSP830	M8 x 30	25

PINS & CLIPS

Category 11

Split Pins



48

R-Clips



51

Hi-Spring Clip



54

Double Coil R-Clip



54

Hair Pin Clips



52

Linch Pins



55

Shaft Locking Pins



57

Clevis Pins



60

Plating / Material:

Zinc Plated & Zinc Yellow Plated
Stainless Steel

Specifications:

Split Pins:	DIN 94
R-Clips:	Refer Drawing
Double Coil R-Clip:	DIN 11024
Hair Pin:	Refer Drawing
Linch Pin:	Refer Drawing
Shaft Locking:	Refer Drawing
Clevis Pins:	ASME B18.8.1

PINS & CLIPS - Category II

SPLIT PIN
STEEL - METRIC
ZINC PLATED



M 1.6		Qty
MSSPZP1610	1.6 x 10	200
MSSPZP1612	1.6 x 12	200
MSSPZP1616	1.6 x 16	200
MSSPZP1620	1.6 x 20	200
MSSPZP1622	1.6 x 22	200
MSSPZP1625	1.6 x 25	200
MSSPZP1628	1.6 x 28	200
MSSPZP1632	1.6 x 32	200
MSSPZP1636	1.6 x 36	200
MSSPZP1640	1.6 x 40	200
MSSPZP1650	1.6 x 50	200

M 2		Qty
MSSPZP212	2 x 12	200
MSSPZP216	2 x 16	200
MSSPZP220	2 x 20	200
MSSPZP222	2 x 22	200
MSSPZP225	2 x 25	200
MSSPZP228	2 x 28	200
MSSPZP232	2 x 32	200
MSSPZP236	2 x 36	200
MSSPZP240	2 x 40	200
MSSPZP250	2 x 50	200

M 2.5		Qty
MSSPZP2512	2.5 x 12	200
MSSPZP2516	2.5 x 16	200
MSSPZP2520	2.5 x 20	200
MSSPZP2522	2.5 x 22	200
MSSPZP2525	2.5 x 25	200
MSSPZP2528	2.5 x 28	200
MSSPZP2532	2.5 x 32	200
MSSPZP2536	2.5 x 36	200
MSSPZP2540	2.5 x 40	200
MSSPZP2545	2.5 x 45	200
MSSPZP2550	2.5 x 50	200
MSSPZP2556	2.5 x 56	200
MSSPZP2563	2.5 x 63	200

M 3.2		Qty
MSSPZP3212	3.2 x 12	200
MSSPZP3216	3.2 x 16	200
MSSPZP3220	3.2 x 20	200
MSSPZP3225	3.2 x 25	200

M 3.2 Continued		Qty
MSSPZP3232	3.2 x 32	200
MSSPZP3236	3.2 x 36	200
MSSPZP3240	3.2 x 40	200
MSSPZP3245	3.2 x 45	200
MSSPZP3250	3.2 x 50	200
MSSPZP3256	3.2 x 56	200
MSSPZP3263	3.2 x 63	200
MSSPZP3271	3.2 x 71	200
MSSPZP3280	3.2 x 80	200

M 4		Qty
MSSPZP420	4 x 20	200
MSSPZP425	4 x 25	200
MSSPZP428	4 x 28	200
MSSPZP432	4 x 32	200
MSSPZP436	4 x 36	200
MSSPZP440	4 x 40	200
MSSPZP445	4 x 45	200
MSSPZP450	4 x 50	200
MSSPZP456	4 x 56	200
MSSPZP463	4 x 63	200
MSSPZP471	4 x 71	200
MSSPZP480	4 x 80	200
MSSPZP490	4 x 90	200
MSSPZP4100	4 x 100	200

M 5		Qty
MSSPZP520	5 x 20	200
MSSPZP525	5 x 25	200
MSSPZP528	5 x 28	200
MSSPZP532	5 x 32	200
MSSPZP536	5 x 36	200
MSSPZP540	5 x 40	200
MSSPZP545	5 x 45	200
MSSPZP550	5 x 50	200
MSSPZP556	5 x 56	200
MSSPZP563	5 x 63	200
MSSPZP571	5 x 71	200
MSSPZP580	5 x 80	200
MSSPZP590	5 x 90	200
MSSPZP5100	5 x 100	200
MSSPZP5125	5 x 125	200

M 6.3		Qty
MSSPZP6325	6.3 x 25	200
MSSPZP6332	6.3 x 32	200
MSSPZP6336	6.3 x 36	200
MSSPZP6340	6.3 x 40	200
MSSPZP6345	6.3 x 45	200
MSSPZP6350	6.3 x 50	200
MSSPZP6356	6.3 x 56	200
MSSPZP6363	6.3 x 63	200
MSSPZP6371	6.3 x 71	200
MSSPZP6380	6.3 x 80	200
MSSPZP6390	6.3 x 90	200
MSSPZP63100	6.3 x 100	200
MSSPZP63125	6.3 x 125	200
MSSPZP63150	6.3 x 150	100

M 8		Qty
MSSPZP850	8 x 50	100
MSSPZP856	8 x 56	100
MSSPZP863	8 x 63	100
MSSPZP871	8 x 71	100
MSSPZP880	8 x 80	100
MSSPZP890	8 x 90	100
MSSPZP8100	8 x 100	100
MSSPZP8125	8 x 125	100
MSSPZP8150	8 x 150	100

M 10		Qty
MSSPZP1050	10 x 50	100
MSSPZP1063	10 x 63	100
MSSPZP1071	10 x 71	100
MSSPZP1080	10 x 80	100
MSSPZP1090	10 x 90	100
MSSPZP10100	10 x 100	100
MSSPZP10125	10 x 125	100
MSSPZP10150	10 x 150	50

M 13		Qty
MSSPZP1350	13 x 50	50
MSSPZP1363	13 x 63	50
MSSPZP1380	13 x 80	50
MSSPZP13100	13 x 100	50
MSSPZP13125	13 x 125	50
MSSPZP13150	13 x 150	50

PINS & CLIPS - Category II

SPLIT PIN
METRIC
STAINLESS STEEL
Grade G304



M 1.6		Qty
S4SPP1610	1.6 x 10	200
S4SPP1612	1.6 x 12	200
S4SPP1616	1.6 x 16	200
S4SPP1620	1.6 x 20	200
S4SPP1625	1.6 x 25	200
S4SPP1632	1.6 x 32	200
S4SPP1640	1.6 x 40	200

M 2		Qty
S4SPP210	2 x 10	200
S4SPP212	2 x 12	200
S4SPP216	2 x 16	200
S4SPP220	2 x 20	200
S4SPP225	2 x 25	200
S4SPP232	2 x 32	200
S4SPP240	2 x 40	200

M 2.5		Qty
S4SPP2512	2.5 x 12	200
S4SPP2516	2.5 x 16	200
S4SPP2520	2.5 x 20	200
S4SPP2525	2.5 x 25	200
S4SPP2532	2.5 x 32	200
S4SPP2536	2.5 x 36	200
S4SPP2540	2.5 x 40	200
S4SPP2550	2.5 x 50	200

M 3.2		Qty
S4SPP3212	3.2 x 12	200
S4SPP3216	3.2 x 16	200
S4SPP3220	3.2 x 20	200
S4SPP3225	3.2 x 25	200
S4SPP3232	3.2 x 32	200
S4SPP3236	3.2 x 36	200
S4SPP3240	3.2 x 40	200
S4SPP3245	3.2 x 45	200
S4SPP3250	3.2 x 50	200
S4SPP3263	3.2 x 63	200
S4SPP3280	3.2 x 80	200

M 4		Qty
S4SPP420	4 x 20	100
S4SPP425	4 x 25	100
S4SPP432	4 x 32	100
S4SPP436	4 x 36	100
S4SPP440	4 x 40	100
S4SPP445	4 x 45	100
S4SPP450	4 x 50	100
S4SPP463	4 x 63	100

M 5		Qty
S4SPP520	5 x 20	100
S4SPP525	5 x 25	100
S4SPP532	5 x 32	100
S4SPP536	5 x 36	100
S4SPP540	5 x 40	100
S4SPP545	5 x 45	100
S4SPP550	5 x 50	100
S4SPP563	5 x 63	100
S4SPP571	5 x 71	100
S4SPP580	5 x 80	100
S4SPP590	5 x 90	100
S4SPP5100	5 x 100	100

M 6.3		Qty
S4SPP6325	6.3 x 25	100
S4SPP6332	6.3 x 32	100
S4SPP6340	6.3 x 40	100
S4SPP6345	6.3 x 45	100
S4SPP6350	6.3 x 50	100
S4SPP6363	6.3 x 63	100
S4SPP6380	6.3 x 80	100
S4SPP63100	6.3 x 100	100

M 8		Qty
S4SPP850	8 x 50	50
S4SPP863	8 x 63	50
S4SPP880	8 x 80	50
S4SPP890	8 x 90	50
S4SPP8100	8 x 100	50

M 10		Qty
S4SPP1050	10 x 50	50
S4SPP1063	10 x 63	50
S4SPP1080	10 x 80	50
S4SPP1090	10 x 90	50
S4SPP10100	10 x 100	50
S4SPP10125	10 x 125	50
S4SPP10150	10 x 150	50

PINS & CLIPS - Category II

SPLIT PIN STEEL ASSORTMENT PACK

SPLIT PIN PACK		Qty
SPKIT20	Mixed Sizes	1,570



Split Pin Assortment Pack									
1.5 x 36 200 Pieces	2 x 25 200 Pieces	2.5 x 25 200 Pieces	2.5 x 32 200 Pieces	3.2 x 20 100 Pieces	3 x 25 100 Pieces	5 x 90 25 Pieces	5 x 63 25 Pieces	6.3 x 90 25 Pieces	3.2 x 32 100 Pieces
5 x 40 25 Pieces	6.3 x 63 25 Pieces	8 x 80 20 Pieces	3.2 x 40 50 Pieces	4 x 63 25 Pieces	4 x 50 50 Pieces	4 x 40 50 Pieces	4 x 32 50 Pieces	4 x 25 50 Pieces	3.2 x 50 50 Pieces

PINS & CLIPS - Category II

R-CLIP Humpback Pins STEEL - METRIC Standard Packaging ZINC PLATED



M 1.2	Qty	M 3.2	Qty	M 5	Qty
MSHPZP12	1.2 x 15	200	MSHPZP32	3.2 x 65	200
M 1.6			M 3.5		
MSHPZP16	1.6 x 33	200	MSHPZP35	3.5 x 65	200
M 2			M 3.8		
MSHPZP2	2.0 x 40	200	MSHPZP38	3.8 x 75	200
M 2.4			M 4.5		
MSHPZP24	2.4 x 59	200	MSHPZP45	4.5 x 83	100
			M 6.2		
			MSHPZP62	6.2 x 102	50
			M 7		
			MSHPZP7	7.0 x 104	25
			M 7.9		
			MSHPZP79	7.9 x 104	25

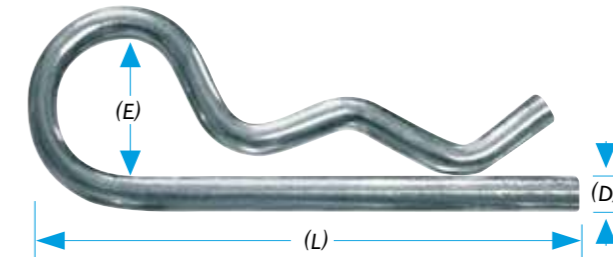

R-Clip Dimension/Insertion Chart

DIA. (D)	PART NUMBER	LENGTH (L)	EYE DIA. (E)	DRILL SIZE	SHAFT MIN.	SHAFT MAX.	PACK SIZE
1.2	MSHPZP12	15	3.18	1.59	3.18	4.76	200
1.6	MSHPZP16	33	7.94	1.98	6.35	12.70	200
2.0	MSHPZP2	40	9.53	2.38	9.53	12.70	200
2.4	MSHPZP24	59	15.88	2.78	9.53	14.29	200
3.2	MSHPZP32	65	14.29	3.57	11.11	19.05	200
3.5	MSHPZP35	65	15.88	3.97	12.70	19.05	200

Dimensions listed may vary. Use a a guide only.

DIA. (D)	PART NUMBER	LENGTH (L)	EYE DIA. (E)	DRILL SIZE	SHAFT MIN.	SHAFT MAX.	PACK SIZE
3.8	MSHPZP38	75	19.05	3.97	15.88	25.40	200
4.5	MSHPZP45	83	23.81	4.76	15.88	25.40	100
5	MSHPZP5	96	23.81	5.50	15.88	25.40	100
6.2	MSHPZP62	102	23.81	6.75	19.05	25.40	50
7	MSHPZP7	104	22.23	7.54	19.05	25.40	25
7.9	MSHPZP79	104	22.23	8.33	22.23	25.40	25

Dimensions listed may vary. Use a a guide only.

PINS & CLIPS - Category II

R-CLIP Humpback Pins STEEL - METRIC Hanger/Hardware Packs ZINC PLATED



Part Number	Size	Qty
M 1.6 MSHPZP16-HP	1.6 x 33	10
M 2 MSHPZP2-HP	2.0 x 40	10
M 2.4 MSHPZP24-HP	2.4 x 59	10
M 3.2 MSHPZP32-HP	3.2 x 65	10
M 3.5 MSHPZP35-HP	3.5 x 65	10
M 3.8 MSHPZP38-HP	3.8 x 75	5

Part Number	Size	Qty
M 4.5 MSHPZP45-HP	4.5 x 83	5
M 5 MSHPZP5-HP	5.0 x 96	5
M 6.2 MSHPZP62-HP	6.2 x 102	5
M 7 MSHPZP7-HP	7.0 x 104	5
M 7.9 MSHPZP79-HP	7.9 x 104	5



R-CLIP Humpback Pins RETAIL STAND ZINC PLATED STEEL PACKS Self standing black wire frame

Humpback Pin Counter Display Stand (Approx. 40cm wide, 75cm high, 12cm deep) - Contains 11 R-Clip sizes, each in a Snap Lock re-sealable plastic bag complete with barcoded header card (Each stand contains 5 Bags per size from 1.6 to 4.5 and 3 bags per size from 5.0 to 7.9mm). The stand also includes a Header Display Selection chart for ease of choosing the correct size.



Stand dimensions
40cm wide x 75cm high x 12cm deep

Part Number

HPSTAND Packs listed below

R-CLIPS - Zinc Plated

Size Dia.	Length	Quantity
1.6mm	33mm	10 per pack
2.0mm	40mm	10 per pack
2.4mm	59mm	10 per pack
3.2mm	65mm	10 per pack
3.5mm	65mm	10 per pack
3.8mm	75mm	5 per pack
4.5mm	83mm	5 per pack
5.0mm	96mm	5 per pack
6.2mm	102mm	5 per pack
7.0mm	104mm	5 per pack
7.9mm	104mm	5 per pack

PINS & CLIPS - Category II

R-CLIP Humpback Pins STEEL ASSORTMENT PACK ZINC PLATED

Part Number	Size	Qty
R-CLIP Grab Kit HPKIT8	Mixed Sizes	100



R-CLIP Humpback Pins STAINLESS STEEL Grade G304



Part Number	Size	Qty
M 1.2 S4HPP12	1.2 x 15	100
M 1.6 S4HPP16	1.6 x 33	100
M 2 S4HPP2	2.0 x 40	100

Part Number	Size	Qty
M 2.4 S4HPP24	2.4 x 59	100
M 3.2 S4HPP32	3.2 x 65	50
M 3.8 S4HPP38	3.8 x 75	50

Part Number	Size	Qty
M 5 S4HPP5	5.0 x 96	25
M 6.2 S4HPP62	6.2 x 102	25

R-CLIP STAINLESS STEEL Grade G304 Humpback Pins- METRIC Individual Hanger Packs

R-Clip - Stainless Steel Grade 304

Size	Quantity	Part Number
1.2 x 15mm	10 per pack	S4HPP12-HP
1.6 x 33mm	10 per pack	S4HPP16-HP
2.0 x 40mm	10 per pack	S4HPP2-HP
2.4 x 59mm	10 per pack	S4HPP24-HP
3.2 x 65mm	10 per pack	S4HPP32-HP
3.8 x 75mm	5 per pack	S4HPP38-HP
5.0 x 96mm	5 per pack	S4HPP5-HP
6.2 x 102mm	5 per pack	S4HPP62-HP



PINS & CLIPS - Category II

DOUBLE COIL R-CLIP
Spring Tensioned
STEEL - METRIC
ZINC PLATED



HI-SPRING
Spring Tensioned R-Clips
STEEL - METRIC
ZINC PLATED

M 2	Qty
MSDCHPZP2 2.0mm	25

M 3	Qty
MSDCHPZP3 3.0mm	25

M 4	Qty
MSDCHPZP4 4.0mm	25

M 5	Qty
MSDCHPZP5 5.0mm	25

M 6	Qty
MSDCHPZP6 6.0mm	25

M 8	Qty
MSDCHPZP8 8.0mm	25

M 3.5	Qty
MSSTHPZP35 3.5mm	25

HAIR PIN RETAINER CLIP
STEEL
ZINC PLATED

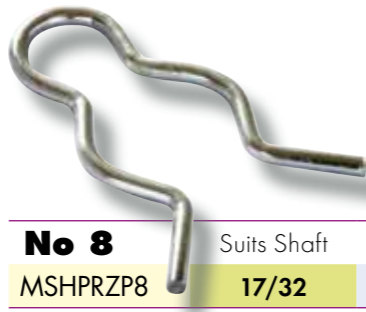

No 3	Suits Shaft	Qty
MSHPRZP3 7/32		50

No 5	Suits Shaft	Qty
MSHPRZP5 5/16		50

No 8	Suits Shaft	Qty
MSHPRZP8 17/32		50

No 11	Suits Shaft	Qty
MSHPRZP11 7/8		50

HAIR PIN STEEL ASSORTMENT PACK



HAIRKIT4	Qty
Mixed Sizes	130

LINCH PINS STAINLESS STEEL MARINE GRADE 316 - Stamped A4



S6LPP45	Qty
4.5 x 40	10
S6LPP6 6 x 40	10
S6LPP8 8 x 40	10

LINCH PINS STEEL MECHANICALLY GALVANISED

LPHP6	Qty
6 x 40	25

PINS & CLIPS - Category II

LINCH PINS STEEL - METRIC Standard Packaging
ZINC YELLOW PLATED



M 4.5	Qty
LPYP45 4.5 x 40	25

M 6	Qty
LPYP6 6 x 40	25

M 8	Qty
LPYP8 8 x 40	25

M 11	Qty
LPYP1140 11 x 40	25

LPYP1150 11 x 50	25
LPYP1170 11 x 70	25

LINCH PINS STEEL ASSORTMENT PACK

LPKIT6	Qty
Mixed Sizes	24



LINCH PINS STEEL - METRIC Hanger/Hardware Packs
ZINC YELLOW PLATED



M 4.5	Qty
LPYP45-HP 4.5 x 40	5

LPYP6-HP 6 x 40	5
-----------------	---

LPYP8-HP 8 x 40	5
-----------------	---

M 11	Qty
LPYP1140-HP 11 x 40	3

LPYP1150-HP 11 x 50	3
LPYP1170-HP 11 x 70	3



PINS & CLIPS - Category II

LINCH PIN
STAINLESS STEEL G316
MARINE GRADE METRIC
Hanger/Hardware
Individual Packs

Linch Pin - Stainless Steel 316 Marine Grade

Size	Quantity	Part Number
4.5 x 40mm	3 per pack	S6LPP45-HP
6 x 40mm	3 per pack	S6LPP6-HP
8 x 40mm	3 per pack	S6LPP8-HP



STANDARD LINCH PIN

Mild Steel, Zinc Yellow

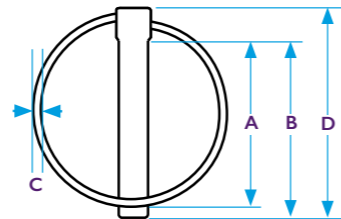

Pin Dia.	A	B	C	D
4.5mm	32	40	2.5	47
6mm	32	40	3	47
8mm	32	40	3	48
11mm	35	40	3.5	52
11mm	45	50	3.5	60
11mm	65	70	3.5	82

Dimensions listed may vary. Use a a guide only.

SHAFT LOCKING PIN

Round Type-Mild Steel, Zinc Yellow

Suitable for Round Shafts up to 2" Dia.

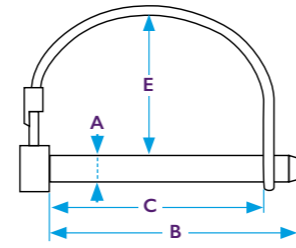

Pin Dia.	A	B	C	E
6mm	65	55	37	
8mm	65	55	37	
10mm	65	58	37	

Dimensions listed may vary. Use a a guide only.

SHAFT LOCKING PIN

Square Type-Mild Steel, Zinc Yellow

Suitable for Square Shafts up to 2" Dia.

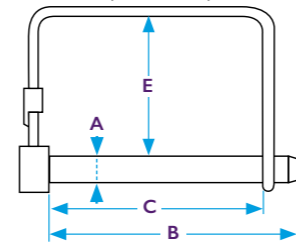

Pin Dia.	A	B	C	E
6mm	65	55	37	
8mm	65	55	37	
10mm	65	55	37	

Dimensions listed may vary. Use a a guide only.



SHAFT LOCKING PINS
Pipe (PTO) Clips
- Suits 2" Shafts
Standard Packaging
STEEL - METRIC
ZINC YELLOW PLATED

M 6	Qty
SLYP6	6mm 25
M 8	Qty
SLYP8	8mm 25
M 10	Qty
SLYP10	10mm 25

SHAFT LOCKING PINS
Pipe (PTO) Clips
- Suits 2" Shafts
Standard Packaging
STAINLESS STEEL
GRADE 304 - METRIC

M 6	Qty
S4SLP6	6mm 10
M 8	Qty
S4SLP8	8mm 10
M 10	Qty
S4SLP10	10mm 10

PINS & CLIPS - Category II

SHAFT LOCKING PINS
SQUARE TYPE
Pipe (PTO) Clips
- Suits 2" Shafts
Standard Packaging
STEEL - METRIC
ZINC YELLOW PLATED

M 6	Qty
SLSQYP6	6mm 25
M 8	Qty
SLSQYP8	8mm 25
M 10	Qty
SLSQYP10	10mm 25



SHAFT LOCKING PINS
Pipe (PTO) Clips - Suits 2" Shafts - Hanger/Hardware Packs
STEEL - METRIC
ZINC YELLOW PLATED

6	Qty
SLYP6-HP	6mm 3
8	Qty
SLYP8-HP	8mm 3
10	Qty
SLYP10-HP	10mm 3



SHAFT LOCKING PINS
- Suits 2" Shafts -
STAINLESS STEEL Grade
G304 METRIC
Hanger/Hardware
Individual Packs

Shaft Lock Pin - Stainless Steel 304 Grade

Size	Quantity	Part Number
M6	2 per pack	S4SLP6-HP
M8	2 per pack	S4SLP8-HP
M10	2 per pack	S4SLP10-HP



PINS & CLIPS - Category II

LINCH PIN & SHAFT LOCKING PIN RETAIL STAND ZINC YELLOW PLATED Self standing black wire frame

Linch Pin & Shaft Locking Pin Counter Display Stand (Approx. 40cm wide, 75cm high, 12cm deep) - Contains 9 Linch & Shaft Pin sizes, each in a Snap Lock re-sealable plastic bag complete with barcoded header card (Linch Pin Diameters range from 4.5mm to 11mm, and the Shaft Locking Pins range from 6mm to 10mm). The stand also includes a Header Display Card for ease of choosing the correct size)

Part Number

LSLSTAND Packs listed below

LINCH PIN Zinc Yellow Plated

Size	Quantity
4.5 x 40mm	5 per pack
6 x 40mm	5 per pack
8 x 40mm	5 per pack
11 x 40mm	3 per pack
11 x 50mm	3 per pack
11 x 70mm	3 per pack

SHAFT LOCKING PIN Zinc Yellow Plated

6mm	3 per pack
8mm	3 per pack
10mm	3 per pack



Stand dimensions
40cm wide x 75cm high x 20cm deep

PINS & CLIPS - Category II

STAINLESS STEEL HANG PACK SWIVEL STAND Linch Pin, Shaft Lock Pins and R-Clips in individual packs - METRIC Self standing black wire frame on swivel base

Part Number

SSPINSTAND Packs listed below

Linch Pin - Stainless Steel 316 Marine Grade

Size	Quantity	Part Number
4.5 x 40mm	3 per pack	S6LPP45-HP
6 x 40mm	3 per pack	S6LPP6-HP
8 x 40mm	3 per pack	S6LPP8-HP

Shaft Lock Pin - Stainless Steel 304 Grade

M6	2 per pack	S4SLP6-HP
M8	2 per pack	S4SLP8-HP
M10	2 per pack	S4SLP10-HP

R-Clip - Stainless Steel 304 Grade

1.2 x 15mm	10 per pack	S4HPP12-HP
1.6 x 33mm	10 per pack	S4HPP16-HP
2.0 x 40mm	10 per pack	S4HPP2-HP
2.4 x 59mm	10 per pack	S4HPP24-HP
3.2 x 65mm	10 per pack	S4HPP32-HP
3.8 x 75mm	5 per pack	S4HPP38-HP
5.0 x 96mm	5 per pack	S4HPP5-HP
6.2 x 102mm	5 per pack	S4HPP62-HP



Stand dimensions
20 x 20 x 70cm

PINS & CLIPS - Category 11

CLEVIS PINS
STEEL - IMPERIAL
ZINC PLATED



1/4		Qty
MSCLZP1434	1/4 x 3/4	25
MSCLZP1478	1/4 x 7/8	25
MSCLZP141	1/4 x 1	25
MSCLZP14114	1/4 x 1 1/4	25
MSCLZP14112	1/4 x 1 1/2	25
5/16		
MSCLZP51634	5/16 x 3/4	25
MSCLZP51678	5/16 x 7/8	25
MSCLZP5161	5/16 x 1	25
MSCLZP516114	5/16 x 1 1/4	25
MSCLZP516112	5/16 x 1 1/2	25
MSCLZP516134	5/16 x 1 3/4	25
MSCLZP5162	5/16 x 2	25

3/8		Qty
MSCLZP381	3/8 x 1	25
MSCLZP38118	3/8 x 1 1/8	25
MSCLZP38114	3/8 x 1 1/4	25
MSCLZP38112	3/8 x 1 1/2	25
MSCLZP382	3/8 x 2	25
7/16		
MSCLZP716138	7/16 x 1 3/8	25
MSCLZP716112	7/16 x 1 1/2	25

1/2		Qty
MSCLZP12114	1/2 x 1 1/4	25
MSCLZP12138	1/2 x 1 3/8	25
MSCLZP12112	1/2 x 1 1/2	25
MSCLZP122	1/2 x 2	25

CLEVIS PIN Grab Kit		Qty
CPKIT16	16 Mixed Sizes	230



BRASS FLAT WASHERS

Category 12

Brass Flat Washer



BRASS WASHER FLAT - METRIC

M 3		Qty
BRFWP3	M3 x 7 x 0.5mm	200
M 4		Qty
BRFWP4	M4 x 9 x 0.8mm	200

M 5		Qty
BRFWP5	M5 x 10 x 0.8mm	200
M 6		Qty
BRFWP6	M6 x 12.5 x 1mm	100

M 10		Qty
BRFWP10	M10 x 21 x 1.2mm	25
M 12		Qty
BRFWP12M	M12 x 24 x 1.6mm	25

M 8		Qty
BRFWP8	M8 x 17 x 1.2mm	50

BRASS WASHER FLAT - IMPERIAL

1/8		Qty
BRFWP18516	1/8 x 5/16 x 21g	200
BRFWP1838	1/8 x 3/8 x 21g	200
5/32		Qty
BRFWP53238	5/32 x 3/8 x 21g	200
BRFWP532716	5/32 x 7/16 x 21g	200

3/16		Qty
BRFWP316716	3/16 x 7/16 x 21g	200
BRFWP31612	3/16 x 1/2 x 21g	200
1/4		Qty
BRFWP1412	1/4 x 1/2 x 21g	100
BRFWP1458	1/4 x 5/8 x 19g	100
BRFWP14916	1/4 x 9/16 x 19g	100

5/16		Qty
BRFWP51658	5/16 x 5/8 x 18g	50
BRFWP51634	5/16 x 3/4 x 18g	50
3/8		Qty
BRFWP3834	3/8 x 3/4 x 16g	25
BRFWP3878	3/8 x 7/8 x 18g	25

Specifications:

Metric:	AS 1234
Imperial:	BS 3410

Post Combination Square/Phillips Case Hardened Zinc Alloy (Super Zinc) Plated Machine Screws

62



Pan Head POST SQUARE/PHILLIPS DRIVE STEEL - METRIC ZINC ALLOY PLATED

M 6		Qty
MSPQPAP612	6 x 12	200
MSPQPAP616	6 x 16	200
MSPQPAP620	6 x 20	200
MSPQPAP625	6 x 25	200



Countersunk Head POST SQUARE/PHILLIPS DRIVE STEEL - METRIC ZINC ALLOY PLATED

M 6		Qty
MSCQPAP612	6 x 12	200
MSCQPAP616	6 x 16	200
MSCQPAP620	6 x 20	200
MSCQPAP625	6 x 25	200

Security Screw Grab Kit	Qty
SECKIT8	8 Mixed Sizes 200

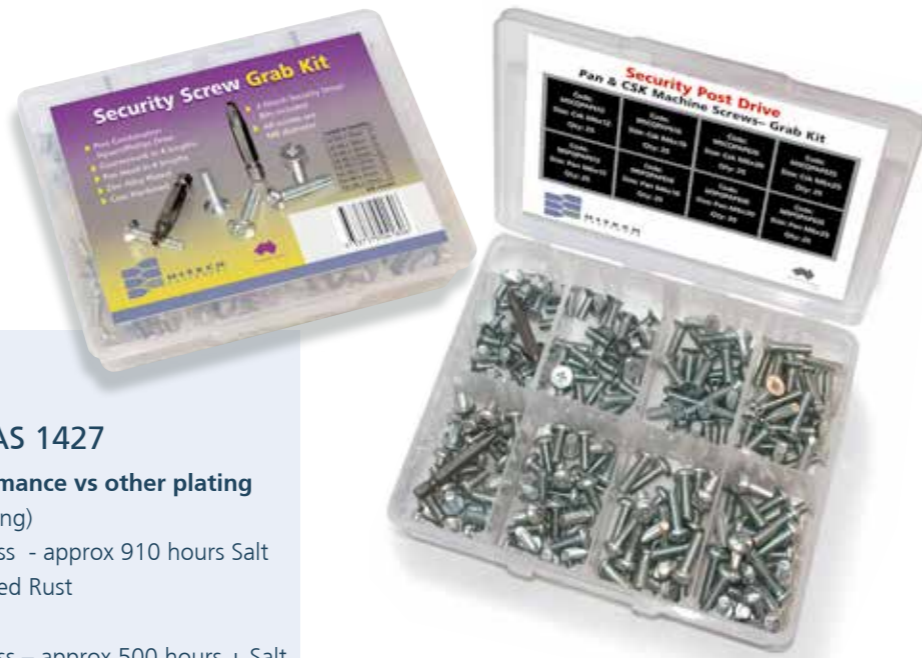

Specifications:

Metric: AS 1427

Zinc Alloy Plating Performance vs other plating
HDG (Hot Dipped Galvanising)

84um plating thickness - approx 910 hours Salt
Spray tested before Red Rust

Mechanical Galvanising

15um plating thickness - approx 500 hours + Salt
Spray tested before Red Rust

Super Zinc (Zinc Alloy)

15um plating thickness - approx 1000 hours Salt
Spray tested before Red Rust

Round Head Zinc Clear



63

Round Head U-DRIVE STEEL ZINC PLATED CASE HARDENED



00G		Qty
UDS0018	00G X 1/8	1000
UDS00316	00G X 3/16	1000
UDS0014	00G X 1/4	1000

0G		Qty
UDS018	0G X 1/8	1000
UDS0316	0G X 3/16	1000
UDS014	0G X 1/4	1000

2G		Qty
UDS218	2G X 1/8	1000
UDS2316	2G X 3/16	1000
UDS214	2G X 1/4	1000
UDS2516	2G X 5/16	1000

4G		Qty
UDS4316	4G X 3/16	1000
UDS414	4G X 1/4	1000
UDS4516	4G X 5/16	1000
UDS438	4G X 3/8	1000

6G		Qty
UDS614	6G X 1/4	1000
UDS6516	6G X 5/16	1000
UDS638	6G X 3/8	1000
UDS612	6G X 1/2	1000

8G		Qty
UDS838	8G X 3/8	1000
UDS812	8G X 1/2	1000

10G		Qty
UDS1038	10G X 3/8	1000
UDS1012	10G X 1/2	1000
UDS1058	10G X 5/8	1000

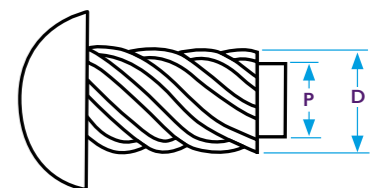

U-DRIVE Screw Dimensional Chart

Gauge	D Outside Dia.		P Pilot Dia.		Recommended Hole Size	
	Max	Min	Max	Min	Drill Size No.	Hole Dia.
00	0.06	0.049	0.046	0.046	55	0.052
0	0.075	0.063	0.06	0.06	51	0.067
2	0.1	0.083	0.08	0.08	44	0.086
4	0.116	0.096	0.092	0.092	37	0.104
6	0.14	0.116	0.112	0.112	31	0.12
8	0.167	0.136	0.132	0.132	27	0.144
10	0.182	0.15	0.146	0.146	20	0.161

Dimensions listed may vary. Use a guide only.

Specifications:

ANSI B 18.6.4

DRIVER BITS 1/4 A/F

Category 15

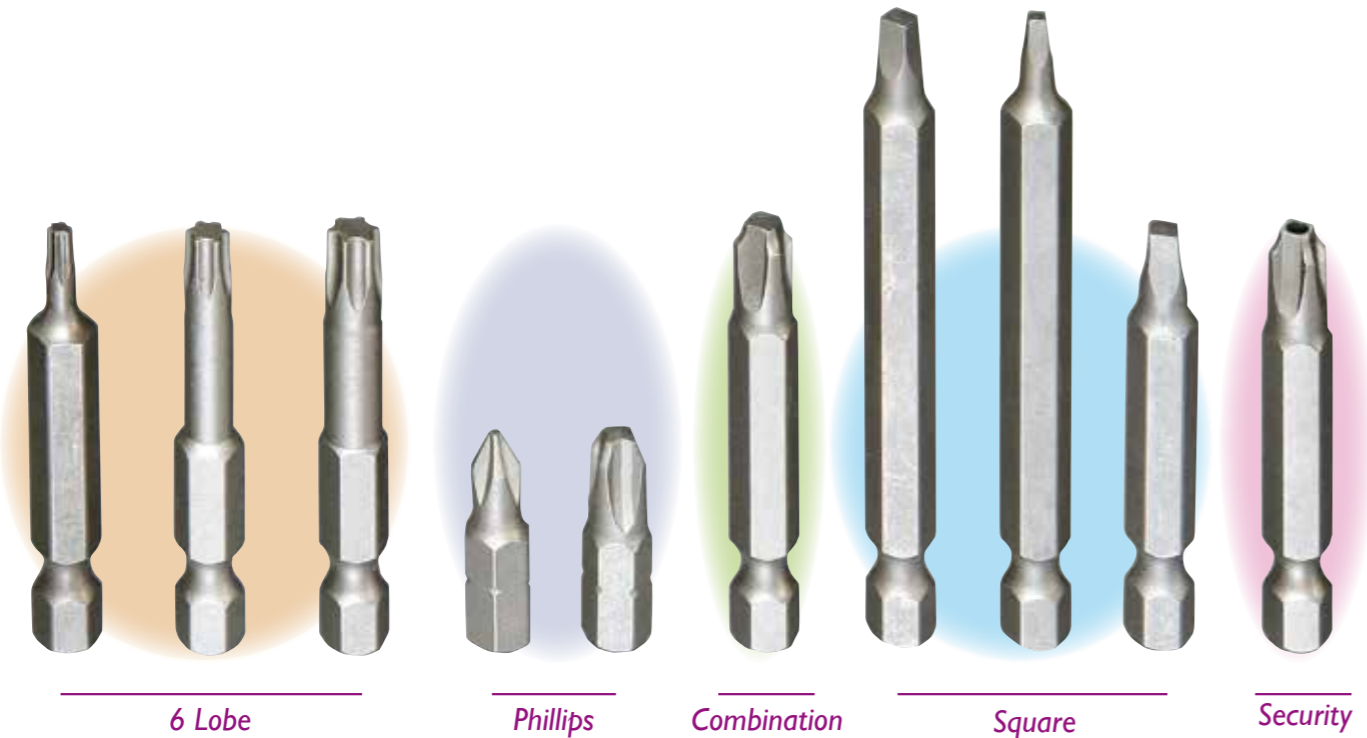

6 Lobe		
		Qty
TDB3	T10	1
TDB4	T20	1
TDB5	T25	1
TDB6	T30	1
Phillips		
PDB0	#0 x 25mm	1
PDB1	#1 x 25mm	1
PDB2	#2 x 25mm	1
PDB3	#3 x 25mm	1

Comb.Square/Phil		
		Qty
CDB050	#0 x 50mm	1
CDB150	#1 x 50mm	1
CDB175	#1 x 75mm	1
CDB1100	#1 x 100mm	1
CDB250	#2 x 50mm	1
CDB275	#2 x 75mm	1
CDB2100	#2 x 100mm	1
CDB350	#3 x 50mm	1

Square		
		Qty
SDB0	#0 x 25mm	1
SDB075	#0 x 75mm	1
SDB1	#1 x 25mm	1
SDB175	#1 x 75mm	1
SDB2	#2 x 25mm	1
SDB275	#2 x 75mm	1
SDB3	#3 x 25mm	1
SDB375	#3 x 75mm	1

Security Post Square/Phil		
		Qty
PCDB250	#2 x 50mm	1

SCREWS FOR TIMBER

Category 16

Bugle Batten
Stainless Steel G316
Stamped A4



Solid Brass Wood Screws



Steel Brass Plated
Wood Screws
Case Hardened



Specifications:

Bugle Batten: Refer Drawing
Brass Wood Screw: ANSI B 18.6.1
Steel Brass Plated: ANSI B 18.6.1

SCREWS FOR TIMBER - Category 16

**Bugle Batten
SQUARE DRIVE
Decking Screws
Type 17
Grade 316 Stainless
Stamped A4 - Ribbed**



6#		Qty
S6BBSP61	6# x 1	100
S6BBSP6114	6# x 1 1/4	100
S6BBSP6112	6# x 1 1/2	100
S6BBSP62	6# x 2	100
8#		
S6BBSP81	8# x 1	100
S6BBSP8114	8# x 1 1/4	100
S6BBSP8112	8# x 1 1/2	100
S6BBSP82	8# x 2	100

8# Continued		Qty
S6BBSP8214	8# x 2 1/4	100
S6BBSP8212	8# x 2 1/2	100
S6BBSP83	8# x 3	100
10#		
S6BBSP102	10# x 2	100
S6BBSP10214	10# x 2 1/4	100
S6BBSP10212	10# x 2 1/2	100
S6BBSP103	10# x 3	100

12#		Qty
S6BBSP12214	12# x 2 1/4	100
S6BBSP12212	12# x 2 1/2	100
S6BBSP123	12# x 3	100
14#		
S6BBSP14214	14# x 2 1/4	100
S6BBSP14212	14# x 2 1/2	100
S6BBSP143	14# x 3	100
S6BBSP144	14# x 4	100

SCREWS FOR TIMBER - Category 16

**Countersunk Head
PHILLIPS
Wood Screws
STEEL BRASS PLATED
Not solid brass**



4#		Qty
MSWSCBP412	4# x 1/2	200
MSWSCBP434	4# x 3/4	200
6#		
MSWSCBP634	6# x 3/4	200
MSWSCBP61	6# x 1	200
MSWSCBP6114	6# x 1 1/4	200
MSWSCBP6112	6# x 1 1/2	200

8#		Qty
MSWSCBP834	8# x 3/4	200
MSWSCBP81	8# x 1	200
MSWSCBP8114	8# x 1 1/4	200
MSWSCBP8112	8# x 1 1/2	200

10#		Qty
MSWSCBP101	10# x 1	200
MSWSCBP10114	10# x 1 1/4	200
MSWSCBP10112	10# x 1 1/2	200

**Countersunk Head
SOLID BRASS
Wood Screws
SLOT**



2#		Qty
BRWSCSP238	2# x 3/8	200
3#		
BRWSCSP338	3# x 3/8	200
BRWSCSP312	3# x 1/2	200
4#		
BRWSCSP438	4# x 3/8	200
BRWSCSP412	4# x 1/2	200
BRWSCSP458	4# x 5/8	200

6#		Qty
BRWSCSP612	6# x 1/2	200
BRWSCSP658	6# x 5/8	200
BRWSCSP634	6# x 3/4	200
BRWSCSP61	6# x 1	200
BRWSCSP6114	6# x 1 1/4	200
BRWSCSP6112	6# x 1 1/2	200
8#		
BRWSCSP834	8# x 3/4	200
BRWSCSP81	8# x 1	200
BRWSCSP8114	8# x 1 1/4	200
BRWSCSP8112	8# x 1 1/2	200

10#		Qty
BRWSCSP101	10# x 1	200
BRWSCSP10114	10# x 1 1/4	200
BRWSCSP10112	10# x 1 1/2	200
12#		
BRWSCSP12112	12# x 1 1/2	200
BRWSCSP122	12# x 2	200

**Round Head
PHILLIPS/SLOT
COMBINATION
Wood Screws
STEEL BRASS PLATED
Not solid brass**



4#		Qty
MSWSRCBP412	4# x 1/2	200
MSWSRCBP434	4# x 3/4	200

6#		Qty
MSWSRCBP634	6# x 3/4	200
MSWSRCBP61	6# x 1	200
MSWSRCBP6114	6# x 1 1/4	200
MSWSRCBP6112	6# x 1 1/2	200

8#		Qty
MSWSRCBP834	8# x 3/4	200
MSWSRCBP81	8# x 1	200
MSWSRCBP8114	8# x 1 1/4	200
MSWSRCBP8112	8# x 1 1/2	200
10#		
MSWSRCBP101	10# x 1	200
MSWSRCBP10114	10# x 1 1/4	200
MSWSRCBP10112	10# x 1 1/2	200

HEXAGON MILD STEEL BOLTS & SET SCREWS

Category 17

Hexagon Bolt & Nut



69

Hexagon Set Screws

71

68

Plating / Material:

Commercial Grade Steel Zinc Plated

Specifications:

Metric Hex Bolt:	AS 1111
Metric Hex Nut:	AS 1112
Imperial Hex Bolt:	AS 2451
Imperial Hex Nut:	AS 2451
Metric Hex Set Screw:	M4 AS 1110
Metric Hex Set Screw:	M5-M12 AS 1111
Imperial Hex Set Screw:	3/16 Ref. Drawing
Imperial Hex Set Screw:	1/4-1/2 AS 2451

INDEX

HEXAGON MILD STEEL BOLTS & SET SCREWS - Category 17

Hexagonal Head
BOLT & NUT
STEEL - METRIC
Class 4.6
ZINC PLATED



M 6		Qty
MSHBNZP620*	6 x 20	200
MSHBNZP625	6 x 25	200
MSHBNZP630	6 x 30	200
MSHBNZP635	6 x 35	200
MSHBNZP640	6 x 40	200
MSHBNZP645	6 x 45	200
MSHBNZP650	6 x 50	200
MSHBNZP655	6 x 55	150
MSHBNZP660	6 x 60	150
MSHBNZP665	6 x 65	150
MSHBNZP670	6 x 70	150
MSHBNZP675	6 x 75	150
MSHBNZP680	6 x 80	150
MSHBNZP685	6 x 85	150
MSHBNZP690	6 x 90	150
MSHBNZP6100	6 x 100	150
MSHBNZP6120	6 x 120	100
MSHBNZP6130	6 x 130	100
MSHBNZP6140	6 x 140	100
MSHBNZP6150	6 x 150	100

M 8		Qty
MSHBNZP820*	8 x 20	200
MSHBNZP825*	8 x 25	200
MSHBNZP830	8 x 30	200
MSHBNZP835	8 x 35	200
MSHBNZP840	8 x 40	200
MSHBNZP845	8 x 45	150
MSHBNZP850	8 x 50	150
MSHBNZP855	8 x 55	150
MSHBNZP860	8 x 60	150
MSHBNZP865	8 x 65	150
MSHBNZP870	8 x 70	100
MSHBNZP875	8 x 75	100
MSHBNZP880	8 x 80	100
MSHBNZP885	8 x 85	100
MSHBNZP890	8 x 90	100
MSHBNZP8100	8 x 100	100
MSHBNZP8120	8 x 120	100

M 8 Continued		Qty
MSHBNZP8130	8 x 130	100
MSHBNZP8140	8 x 140	100
MSHBNZP8150	8 x 150	100

M 10		Qty
MSHBNZP1020*	10 x 20	150
MSHBNZP1025*	10 x 25	150
MSHBNZP1030*	10 x 30	150
MSHBNZP1035	10 x 35	150
MSHBNZP1040	10 x 40	150
MSHBNZP1045	10 x 45	150
MSHBNZP1050	10 x 50	75
MSHBNZP1055	10 x 55	75
MSHBNZP1060	10 x 60	75
MSHBNZP1065	10 x 65	75
MSHBNZP1070	10 x 70	75
MSHBNZP1075	10 x 75	75
MSHBNZP1080	10 x 80	75
MSHBNZP1085	10 x 85	50
MSHBNZP1090	10 x 90	50
MSHBNZP10100	10 x 100	50
MSHBNZP10110	10 x 110	50
MSHBNZP10120	10 x 120	50
MSHBNZP10130	10 x 130	50
MSHBNZP10140	10 x 140	50
MSHBNZP10150	10 x 150	50

M 12 Continued		Qty
MSHBNZP1285	12 x 85	150
MSHBNZP1290	12 x 90	100
MSHBNZP12100	12 x 100	100
MSHBNZP12110	12 x 110	100
MSHBNZP12120	12 x 120	100
MSHBNZP12130	12 x 130	75
MSHBNZP12140	12 x 140	75
MSHBNZP12150	12 x 150	75

*Supplied as SET SCREWS

69

INDEX

HEXAGON MILD STEEL BOLTS & SET SCREWS - Category 17

**Hexagonal Head
BOLT & NUT
STEEL - IMPERIAL
Grade 2
ZINC PLATED**



1/4		Qty	5/16 Continued		Qty
MSHBNZP1434*	1/4 x 3/4	200	MSHBNZP5162	5/16 x 2	150
MSHBNZP141	1/4 x 1	200	MSHBNZP516214	5/16 x 2 1/4	150
MSHBNZP14114	1/4 x 1 1/4	200	MSHBNZP516212	5/16 x 2 1/2	150
MSHBNZP14112	1/4 x 1 1/2	200	MSHBNZP516234	5/16 x 2 3/4	100
MSHBNZP14134	1/4 x 1 3/4	200	MSHBNZP5163	5/16 x 3	100
MSHBNZP142	1/4 x 2	200	MSHBNZP516312	5/16 x 3 1/2	100
MSHBNZP14214	1/4 x 2 1/4	150	MSHBNZP5164	5/16 x 4	100
MSHBNZP14212	1/4 x 2 1/2	150	MSHBNZP516412	5/16 x 4 1/2	100
MSHBNZP14234	1/4 x 2 3/4	150	MSHBNZP5165	5/16 x 5	100
MSHBNZP143	1/4 x 3	150	MSHBNZP516512	5/16 x 5 1/2	100
MSHBNZP14312	1/4 x 3 1/2	150	MSHBNZP5166	5/16 x 6	100
MSHBNZP144	1/4 x 4	150			
MSHBNZP14412	1/4 x 4 1/2	150	3/8		
MSHBNZP145	1/4 x 5	100	MSHBNZP3834*	3/8 x 3/4	150
MSHBNZP14512	1/4 x 5 1/2	100	MSHBNZP381*	3/8 x 1	150
MSHBNZP146	1/4 x 6	100	MSHBNZP38114	3/8 x 1 1/4	150
			MSHBNZP38112	3/8 x 1 1/2	150
			MSHBNZP38134	3/8 x 1 3/4	150
5/16			MSHBNZP382	3/8 x 2	100
MSHBNZP51634*	5/16 x 3/4	150	MSHBNZP38214	3/8 x 2 1/4	100
MSHBNZP5161*	5/16 x 1	150	MSHBNZP38212	3/8 x 2 1/2	100
MSHBNZP516114	5/16 x 1 1/4	150	MSHBNZP38234	3/8 x 2 3/4	100
MSHBNZP516112	5/16 x 1 1/2	150	MSHBNZP383	3/8 x 3	100
MSHBNZP516134	5/16 x 1 3/4	150			

3/8 Continued		Qty	1/2 BSW		Qty
MSHBNZP38312	3/8 x 3 1/2	50	MSHBNZP121*	1/2 x 1	25
MSHBNZP384	3/8 x 4	50	MSHBNZP12114*	1/2 x 1 1/4	25
MSHBNZP38412	3/8 x 4 1/2	50	MSHBNZP12112	1/2 x 1 1/2	25
MSHBNZP385	3/8 x 5	50	MSHBNZP12134	1/2 x 1 3/4	25
MSHBNZP38512	3/8 x 5 1/2	50	MSHBNZP122	1/2 x 2	25
MSHBNZP386	3/8 x 6	50	MSHBNZP12214	1/2 x 2 1/4	25
			MSHBNZP12212	1/2 x 2 1/2	25
			MSHBNZP123	1/2 x 3	25
			MSHBNZP12312	1/2 x 3 1/2	25
			MSHBNZP124	1/2 x 4	25
			MSHBNZP12412	1/2 x 4 1/2	25
			MSHBNZP125	1/2 x 5	25
			MSHBNZP12512	1/2 x 5 1/2	25
			MSHBNZP126	1/2 x 6	25

* Supplied as SET SCREWS

HEXAGON MILD STEEL BOLTS & SET SCREWS - Category 17

**Hexagonal Head
SET SCREW
STEEL - METRIC
Class 4.6
ZINC PLATED**



M 4		Qty	M 8		Qty	M 12		Qty
MSHSZP410	4 x 10	200	MSHSZP812	8 x 12	200	MSHSZP1220	12 x 20	100
MSHSZP412	4 x 12	200	MSHSZP816	8 x 16	200	MSHSZP1225	12 x 25	100
MSHSZP416	4 x 16	200	MSHSZP820	8 x 20	200	MSHSZP1230	12 x 30	100
MSHSZP420	4 x 20	200	MSHSZP825	8 x 25	200	MSHSZP1235	12 x 35	100
MSHSZP425	4 x 25	200	MSHSZP830	8 x 30	200	MSHSZP1240	12 x 40	100
MSHSZP430	4 x 30	200	MSHSZP835	8 x 35	200	MSHSZP1250	12 x 50	75
MSHSZP435	4 x 35	200	MSHSZP840	8 x 40	200	MSHSZP1260	12 x 60	75
MSHSZP440	4 x 40	200	MSHSZP845	8 x 45	200	MSHSZP1265	12 x 65	75
MSHSZP445	4 x 45	200	MSHSZP850	8 x 50	200	MSHSZP1275	12 x 75	75
MSHSZP450	4 x 50	200	MSHSZP865	8 x 65	150	MSHSZP1290	12 x 90	50
			MSHSZP875	8 x 75	150	MSHSZP12100	12 x 100	50
M 5			M 10					
MSHSZP510	5 x 10	200	MSHSZP1012	10 x 12	150			
MSHSZP512	5 x 12	200	MSHSZP1016	10 x 16	150			
MSHSZP516	5 x 16	200	MSHSZP1020	10 x 20	150			
MSHSZP520	5 x 20	200	MSHSZP1025	10 x 25	150			
MSHSZP525	5 x 25	200	MSHSZP1030	10 x 30	150			
MSHSZP530	5 x 30	200	MSHSZP1035	10 x 35	150			
MSHSZP535	5 x 35	200	MSHSZP1040	10 x 40	150			
MSHSZP540	5 x 40	200	MSHSZP1045	10 x 45	75			
MSHSZP545	5 x 45	200	MSHSZP1050	10 x 50	75			
MSHSZP550	5 x 50	200	MSHSZP1065	10 x 65	75			
M 6			MSHSZP1075	10 x 75	75			
MSHSZP610	6 x 10	200	MSHSZP1090	10 x 90	50			
MSHSZP612	6 x 12	200	MSHSZP10100	10 x 100	50			
MSHSZP616	6 x 16	200						
MSHSZP620	6 x 20	200						
MSHSZP625	6 x 25	200						
MSHSZP630	6 x 30	200						
MSHSZP635	6 x 35	200						
MSHSZP640	6 x 40	200						
MSHSZP645	6 x 45	200						
MSHSZP650	6 x 50	200						
MSHSZP665	6 x 65	150						
MSHSZP675	6 x 75	150						

HEXAGON MILD STEEL BOLTS & SET SCREWS - Category 17

**Hexagonal Head
SET SCREW
STEEL - IMPERIAL
Grade 2
ZINC PLATED**



3/16		Qty
MSHSZP31638	3/16 x 3/8	200
MSHSZP31612	3/16 x 1/2	200
MSHSZP31658	3/16 x 5/8	200
MSHSZP31634	3/16 x 3/4	200
MSHSZP3161	3/16 x 1	200
MSHSZP316114	3/16 x 1 1/4	200
MSHSZP316112	3/16 x 1 1/2	200
MSHSZP3162	3/16 x 2	200

1/4		Qty
MSHSZP1438	1/4 x 3/8	200
MSHSZP1412	1/4 x 1/2	200
MSHSZP1458	1/4 x 5/8	200
MSHSZP1434	1/4 x 3/4	200
MSHSZP141	1/4 x 1	200
MSHSZP14114	1/4 x 1 1/4	200
MSHSZP14112	1/4 x 1 1/2	200
MSHSZP14134	1/4 x 1 3/4	200
MSHSZP142	1/4 x 2	200
MSHSZP14214	1/4 x 2 1/4	150
MSHSZP14212	1/4 x 2 1/2	150
MSHSZP143	1/4 x 3	150

5/16		Qty
MSHSZP51612	5/16 x 1/2	200
MSHSZP51658	5/16 x 5/8	200
MSHSZP51634	5/16 x 3/4	200
MSHSZP5161	5/16 x 1	200
MSHSZP516114	5/16 x 1 1/4	200
MSHSZP516112	5/16 x 1 1/2	200
MSHSZP516134	5/16 x 1 3/4	200
MSHSZP5162	5/16 x 2	200
MSHSZP516214	5/16 x 2 1/4	150
MSHSZP516212	5/16 x 2 1/2	150
MSHSZP5163	5/16 x 3	150

3/8		Qty
MSHSZP3812	3/8 x 1/2	200
MSHSZP3858	3/8 x 5/8	200
MSHSZP3834	3/8 x 3/4	200
MSHSZP381	3/8 x 1	200
MSHSZP38114	3/8 x 1 1/4	200
MSHSZP38112	3/8 x 1 1/2	200
MSHSZP38134	3/8 x 1 3/4	150
MSHSZP382	3/8 x 2	150
MSHSZP38212	3/8 x 2 1/2	150
MSHSZP383	3/8 x 3	150
MSHSZP38312	3/8 x 3 1/2	100
MSHSZP384	3/8 x 4	100

1/2 BSW		Qty
MSHSZP1234	1/2 x 3/4	100
MSHSZP121	1/2 x 1	100
MSHSZP12114	1/2 x 1 1/4	100
MSHSZP12112	1/2 x 1 1/2	100
MSHSZP122	1/2 x 2	75
MSHSZP12212	1/2 x 2 1/2	75
MSHSZP123	1/2 x 3	75
MSHSZP12312	1/2 x 3 1/2	50
MSHSZP124	1/2 x 4	50

Hitech Fasteners, the big source for small fasteners



Contact us for your nearest stockist.

Our service never stops.

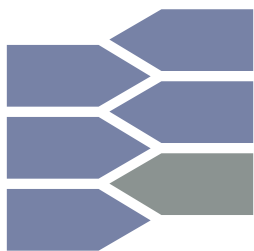

H I T E C H
F A S T E N E R S

Unit 4, 12 Cunningham Street
Moorebank NSW 2170
PO Box 332 Moorebank NSW 1875
Phone: 02 9602 6200
Fax: 02 9601 8800
email: info@hitechfasteners.com.au
www.hitechfasteners.com.au

HITECH Fasteners Aust Pty Ltd
ABN 50 783 784 864